

Appendix D: Geologic Section Well Logs

NORTH AMERICAN SUBBASIN GROUNDWATER SUSTAINABILITY PLAN

APPENDIX D Geologic Section Well Logs

December 2021

Geologic Section A-A'

ORIGINAL

File with DWR

STATE OF CALIFORNIA THE RESOURCES AGENCY DEPARTMENT OF WATER RESOURCES WATER WELL DRILLERS REPORT

Do not fill in No. 244954

No. of Intent No. Local Permit No. or Date

State Well No. Other Well No. 12N03E02F

(2) LOCATION OF WELL (See instructions): County Sutter Owner's Well Number Well address if different from above Township Range Section Distance from cities, roads, railroads, fences, etc.

1.8 mi south of Yuba City on Garden Hwy

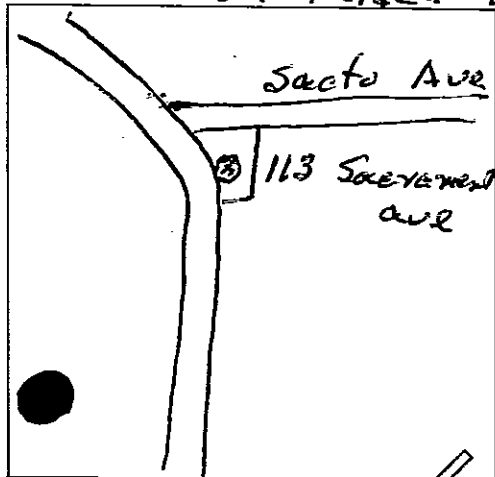

WELL LOCATION SKETCH

(3) TYPE OF WORK:

- New Well Deepening Reconstruction Reconditioning Horizontal Well Destruction Proposed Use: Domestic Irrigation Industrial Test Well Stock Municipal Other

(12) WELL LOG: Total depth ft. Depth of completed well ft. from ft. to ft. Formation (Describe by color, character, size or material)

0-4 - Soil 4-12 - Hard pan 12-42 - Soft Sandy Clay 42-60 - Bl Clay 60-72 - Sandy Bl Clay 72-80 - Bl Sand gravel in Bottom

(5) EQUIPMENT: Rotary Cable Other Reverse Air Bucket

(6) GRAVEL PACK: Yes No Size Diameter of bore Packed from to

(7) CASING INSTALLED: Steel Plastic Concrete

(8) PERFORATIONS: Type of perforation or size of screen

Table with columns: From ft., To ft., Dia. in., Gage of Wall, From ft., To ft., Slot size

(9) WELL SEAL: Was surface sanitary seal provided? Were strata sealed against pollution? Method of sealing

(10) WATER LEVELS: Depth of first water, if known Standing level after well completion

(11) WELL TESTS: Was well test made? Type of test Depth to water at start of test At end of test

Work started 3/8 1985 Completed 3/12 1985

WELL DRILLER'S STATEMENT:

This well was drilled under my jurisdiction and this report is true to the best of my knowledge and belief. SIGNED Henry J. Herr (Well Driller) NAME Henry J. Herr ADDRESS 2410 Turcan Rd Yuba City Zip 95991 License No. 431172 Date of this report 3/13/85

ORIGINAL

STATE OF CALIFORNIA

Do not fill in

File with DWR

THE RESOURCES AGENCY
DEPARTMENT OF WATER RESOURCES
WATER WELL DRILLERS REPORT

No. 244968

of Intent No.
Permit No. or Date

State Well No.
Other Well No. 12N03E02

(1) OW

Address
City

(2) LOCATION OF WELL (See instructions):
County Sutter Owner's Well Number

Well address if different from above
Township Range Section
Distance from cities, roads, railroads, fences, etc.
18 mi. south of Yuba City
on Garden Hiway

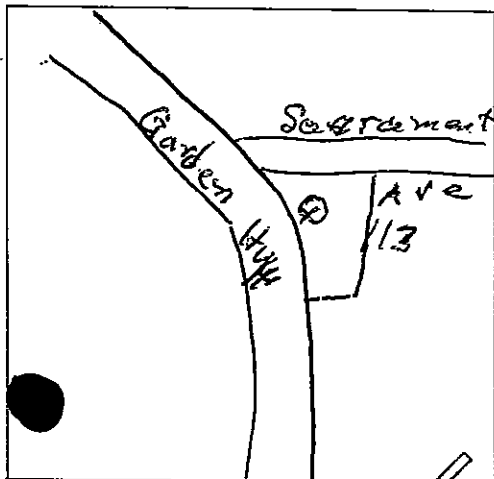

WELL LOCATION SKETCH

(3) TYPE OF WORK:

- New Well [X] Deepening []
Reconstruction []
Reconditioning []
Horizontal Well []
Destruction [] (Describe destruction materials and procedures in Item 12)
(4) PROPOSED USE:
Domestic [X]
Irrigation []
Industrial []
Test Well []
Stock []
Municipal []
Other []

(12) WELL LOG: Total depth ft. Depth of completed well ft.
from ft to ft Formation (Describe by color, character, size or material)
0 - 4 Soil
4 - 12 Hardpan
12 - 42 Soft, sandy clay
42 - 60 Blue clay
60 - 72 Sandy, blue clay
72 - 80 Blue cemented sand, gravel in bottom

(5) EQUIPMENT:

- Rotary [] Reverse []
Cable [X] Air []
Other [] Bucket []

(6) GRAVEL PACK:

- Yes [] No [X] Size
Diameter of bore
Packed from to ft

(7) CASING INSTALLED:

- Steel [] Plastic [] Concrete []

(8) PERFORATIONS:

Type of perforation or size of screen

Table with columns: From ft, To ft, Dia. in, Gage or Wall, From ft, To ft, Slot size

(9) WELL SEAL:

Was surface sanitary seal provided? Yes [X] No [] If yes, to depth 50 ft.
Were strata sealed against pollution? Yes [X] No [] Interval 0' - 54 ft.
Method of sealing Casing landed in clay

(10) WATER LEVELS:

Depth of first water, if known ft.
Standing level after well completion ft.

(11) WELL TESTS:

Was well test made? Yes [] No [] If yes, by whom?
Type of test Pump [] Bailer [] Air lift []
Depth to water at start of test ft. At end of test ft.
Flow rate gal/min after hours Water temperature
Chemical analysis made? Yes [] No [] If yes, by whom?
Was electric log made? Yes [] No [] If yes, attach copy to this report

Work started 5/8 19 85 Completed 5/12 19 85

WELL DRILLER'S STATEMENT:

This well was drilled under my jurisdiction and this report is true to the best of my knowledge and belief.

SIGNED Henry T. Herr (Well Driller)
NAME Henry T. Herr, Well-Drilling, Inc
Address 2410 Tuscan Rd.
City Yuba City Zip 95991
License No. 431172 Date of this report 5/15/85

ORIGINAL
File with DWR

STATE OF CALIFORNIA
THE RESOURCES AGENCY
DEPARTMENT OF WATER RESOURCES
WATER WELL DRILLERS REPORT

Do not fill in

No. 340815

Notice of Intent No. _____

State Well No. _____
Other Well No. 12N04E04B

Local Permit No. or Date _____

(
A
C

(12) WELL LOG: Total depth 194 ft. Completed depth 194 ft.
from ft. to ft. Formation (Describe by color, character, size or material)

(2) LOCATION OF WELL (See instructions):

County SUTTER Owner's Well Number _____
Well address if different from above _____
Township 13 Range 4E Section 4
Distance from cities, roads, railroads, fences, etc. _____

0	-	1	TOP
1	-	17	Brown clay
17	-	19	Shell
19	-	34	Brown clay
34	-	36	Shell
36	-	41	Brown clay
41	-	45	SOFT BROWN CLAY
45	-	48	Sand
48	-	54	Brown clay
54	-	58	Sandy Brown clay
58	-	71	Brown clay
71	-	79	Sand
79	-	84	Brown clay
84	-	88	Shell
88	-	89	Brown clay
89	-	93	Shell
93	-	106	Hard Brown clay
106	-	109	Sandy Brown clay
109	-	115	Shell
115	-	128	Brown clay
128	-	130	Shell
130	-	138	SOFT BROWN CLAY
138	-	148	Brown clay
148	-	156	SOFT SANDY BROWN CLAY
156	-	158	Shell
158	-	162	Brown clay
162	-	164	Shell
164	-	168	Brown clay
168	-	172	Shell
172	-	176	Hard Brown clay
176	-	181	Sandy Brown clay
181	-	187	Shell
187	-	190	Sandy Brown clay
190	-	194	Shell

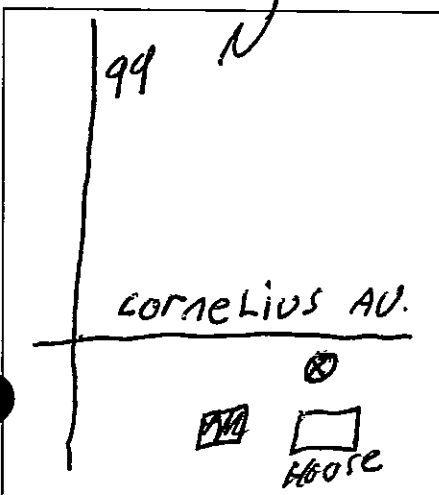

- (3) TYPE OF WORK:
New Well Deepening
Reconstruction
Reconditioning
Horizontal Well
Destruction (Describe destruction materials and procedures in Item 12)

- (4) PROPOSED USE:
Domestic
Irrigation
Industrial
Test Well
Municipal
Other (Describe)

WELL LOCATION SKETCH

- (5) EQUIPMENT:
Rotary Reverse
Cable Air
Other Bucket

- (6) GRAVEL PACK:
Yes No Size _____
Diameter of bore _____
Packed from _____ to _____

- (7) CASING INSTALLED:
Steel Plastic Concrete

- (8) PERFORATIONS:
Type of perforation or size of screen _____

From ft.	To ft.	Dia. in.	Gage or Wall
0	84	6	10

From ft.	To ft.	Slot size
158	162	Brown clay
162	164	Shell
164	168	Brown clay
168	172	Shell
172	176	Hard Brown clay
176	181	Sandy Brown clay
181	187	Shell
187	190	Sandy Brown clay
190	194	Shell

- (9) WELL SEAL:
Was surface sanitary seal provided? Yes No If yes, to depth 20 ft.
Were strata sealed against pollution? Yes No Interval 20 ft.
Method of sealing _____

- (10) WATER LEVELS:
Depth of first water, if known _____ ft.
Standing level after well completion 30 ft.

- (11) WELL TESTS:
Was well test made? Yes No If yes, by whom? _____
Type of test Pump Bailer Air lift
Depth to water at start of test _____ ft. At end of test _____ ft.
Discharge _____ gal/min after _____ hours Water temperature _____
Chemical analysis made? Yes No If yes, by whom? _____
Was electric log made Yes No If yes, attach copy to this report

Work started 6/26 90 Completed 7/6 90

WELL DRILLER'S STATEMENT:
This well was drilled under my jurisdiction and this report is true to the best of my knowledge and belief.
Signed A. Neal Well Driller
NAME SUPERIOR DRILLING CO.
Address 1146 GRAND AVE (Person, firm, or corporation) (Typed or printed)
City MARSHVILLE CA ZIP 95901
License No. 466272 Date of this report 7-6-90

MD 13N/AE-31J1

REGION _____
COUNTY Sutter
NEAR _____

DIVISION OF WATER RESOURCES

DEPARTMENT OF PUBLIC WORKS
STATE OF CALIFORNIA

BASIN _____
DWR NO. 134 31J1 B & M
Nos. 16-33

51-789

WELL LOG

768

LOCATION _____

OWNER _____

DRILLED BY Crandall and Herr ADDRESS _____

DRILLING METHOD _____ GRAVEL PACKED _____ DATE COMPLETED 3/39

SIZE OF CASING DEPTH _____ STRUCK WATER AT _____

PERFORATIONS _____ SIZE 1 1/2" No. _____

WATER LEVEL BEFORE PERFORATING _____ AFTER _____

TEST DATA: DISCHARGE G. P. M. _____ DRAWDOWN FT. _____ HOURS RUN _____

OTHER DATA AVAILABLE: WATER LEVEL RECORD _____ ANALYSIS _____

SURFACE ELEV. _____ DATUM _____ SOURCE OF INFORMATION Log book

DEPTH	ELEV. OF BOTTOM OF STRATUM	MATERIAL	THICKNESS	SP. YIELD %
3		Soil		
13		Clay, brown		
15		Sand, brown		
36		Clay, brown		
40		Gravel		
50		Gravel, cemented		
68		Clay, brown		
74		Clay, brown, soft		
98		Clay, brown		
108		Sand, brown, cemented		
114		Clay, brown		
116		Sand, cemented		
120		Gravel and sand, caving at 105		

Noted and Coded
As Well 134 31J1 / AE-31J1

FOR FIELD COPIES USE ALTERNATE LINES

LOG OBTAINED BY _____ DATE _____ SHEET 1 OF _____

13N/4E-31K1

WATER WELL DRILLERS REPORT
(Sections 7076, 7077, 7078, Water Code)

LOCATION ~~NOT~~ CHECKED
Do Not Fill In

No. 54781

State Well No. 13N/4-31K1
Other Well No. 13N/4E-3

ORIGINAL
File Original, Duplicate and Triplicate with the
REGIONAL WATER POLLUTION
CONTROL BOARD No. 5
(Insert appropriate number)

STATE OF CALIFORNIA

751

(1) OWNER:

Name _____
Addr 6

(2) LOCATION OF WELL:

County Sutter Owner's number, if any—
R. F. D. or Street No. One Mile North of the East
Nicolaus highway. 1/4 Mile East of the
Feather River

(3) TYPE OF WORK (check):

New well Deepening Reconditioning Abandon
If abandonment, describe material and procedure in Item 11.

(4) PROPOSED USE (check):

Domestic Industrial Municipal
Irrigation Test Well Other

(5) EQUIPMENT:

Rotary
Cable
Dug Well

(6) CASING INSTALLED:

SINGLE <input checked="" type="checkbox"/> DOUBLE <input type="checkbox"/>			Gage or Wall
From	ft. to	Diam.	
1	45	14"	10 RD

If gravel packed

Diameter of Bore	from ft.	to ft.

Type and size of shoe or well ring 3/4x6
Describe joint 3/4x6 Butt Weld

(7) PERFORATIONS:

Type of perforator used None

Size of perforations		in., length, by		Perf. per row	Rows per ft.
From	ft. to	ft.	in.		

(8) CONSTRUCTION:

Was a surface sanitary seal provided? Yes No To what depth _____ ft.
Were any strata sealed against pollution? Yes No If yes, note depth of strata
From _____ ft. to _____ ft.
Method of Sealing _____

(9) WATER LEVELS:

Depth at which water was first found 16 ft.
Standing level before perforating _____ ft.
Standing level after perforating _____ ft.

(10) WELL TESTS:

Was a pump test made? Yes No If yes, by whom? Star Well
Yield: 2300 gal./min. with 55 ft. draw down after 8 hrs.
Temperature of water _____ Was a chemical analysis made? Yes No
Was electric log made of well? Yes No

(11) WELL LOG:

Total depth	82	ft.	Depth of completed well	82	ft.
Formation: Describe by color, character, size of material, and structure.					
ft. to	ft.				
0	16	Top Soil			
16	43	Sand			
43	53	Clay			
53	70	Brown Silt Packed			
70	82	Gravel & Sand			

1 MI NO. OF NICOLAUS CW EL
CENTRO RD, W ON CORNELIUS AVE
1 MI TO WHITE GATE AT 90° TURN
IN RD. SWIM ALONG DIRT RD
TO SWIMMING POOL ADJACENT TO
LEDE, WELL IS WEST OF RD &
NEXT TO POOL

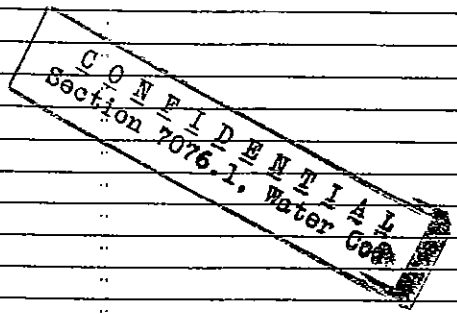

FOR OFFICIAL USE ONLY

Work started 1-25-60 19 _____ Completed 1-28 1960

WELL DRILLER'S STATEMENT:

This well was drilled under my jurisdiction and this report is true to the best of my knowledge and belief.

NAME Star Well Drilling & Pump Co.
(Person, firm, or corporation) (Typed or printed)

Address Live Oak Highway

Yuba City, California

[SIGNED] [Signature]
Well Driller
License No. 121868 Dated 2-2 1960

N.B. location of this well may not agree with Hyde Forbes or Kirk Bryan. This location was obtained from Natomas Co. records and is believed to be correct. 51-791 1

REGION _____
 COUNTY Sutter
 NEAR _____

DIVISION OF WATER RESOURCES

DEPARTMENT OF PUBLIC WORKS
 STATE OF CALIFORNIA

BASIN MD 13N/4E-32H1
 DWR No. 134 32H1 B & M
 SER NOS 16-35

51-791

WELL LOG

165

LOCATION Lot 29, Subdivision 1, Bear River Garden, Subarea, Nicolas Quad
Rio Oso, California

OWNER _____

DRILLED BY Linscott Drilling Co. ADDRESS _____
Log 43

DRILLING METHOD _____ GRAVEL PACKED _____ DATE COMPLETED Aug. 6-Sept. 30, 1913

SIZE OF CASING DEPTH _____ STRUCK WATER AT _____

PERFORATIONS _____ SIZE _____ No. _____

WATER LEVEL BEFORE PERFORATING _____ AFTER _____

TEST DATA: DISCHARGE G. P. M. _____ DRAWDOWN FT. _____ HOURS RUN _____

OTHER DATA AVAILABLE: WATER LEVEL RECORD _____ ANALYSIS _____

SURFACE ELEV. _____ DATUM _____ SOURCE OF INFORMATION DWR - Hyde Forbes

FOR FIELD COPIES USE ALTERNATE LINES

DEPTH	ELEV. OF BOTTOM OF STRATUM	MATERIAL	THICKNESS	SP. YIELD %
10		Top soil	10	
18		Hard pan	8	
30		Soft clay	12	
35		Fine gravel	5	
69		Clay	34	
73		Loose sand	4	
95		Clay	23	
120		Clay and fine gravel	25	
140		Yellow clay	20	
155		White clay	15	
170		Yellow clay	15	
207		All clay with small gravel	37	
210		Sand, gravel, and clay	3	
218		White clay	8	
272		Blue shale	54	
300		Shale and lava	28	
307		Shale	7	
315		Lava	8	
320		Shale	5	
330		Lava	10	
348		Lava sand	18	
395		Blue shale	47	
397		Gravel	2	
405		Shale	8	
430		Lava	25	
435		Shale	5	
450		Lava	15	
463		Blue shale	13	

*Plotted and Coded
 As Well*

LOG OBTAINED BY _____ DATE _____ SHEET 1 OF 2

WELL LOG

LOCAL DESIGNATION 16-35

DEPTH	ELEVATION OF BOTTOM OF STRATUM	MATERIAL	THICKNESS FEET	% VOIDS	ABSOLUTE VOIDS FEET	TOTAL VOIDS FEET
475		Lava	12			
485		Blue shale, sloughing	10			
505		Lava	20			
510		Blue shale	5			
570		Lava	60			
580		Shale	10			
685		Lava	105			
690		Blue shale	5			
710		Lava	20			
735		Blue shale	25			
740		Lava ash	5			
768		Lava	28			
785		Loose lava	17			
795		Hard lava	10			
806		Loose lava	11			
		Casing - 11-5/8" casing 378 ft. deep				
		9-5/8" casing 806 ft. deep				
		Perforations:				
		Double slots from 500' up to 380'				
		600' up to 500'				
		800' up to 600'				
		Some casing pulled out.				
		Test with air line about 200 gals. per minute.				
		Water level 6 ft.				

FOR FIELD COPIES USE ALTERNATE LINES

ORIGINAL
File Original, Duplicate and Triplicate with the
DIVISION OF WATER RESOURCES
P. O. BOX 1079
SACRAMENTO 5, CALIFORNIA

STATE OF CALIFORNIA
DEPARTMENT OF PUBLIC WORKS
DIVISION OF WATER RESOURCES

51-467

SHEET 1

SWR

WATER WELL DRILLERS REPORT

(Sections 7076, 7077, 7078, Water Code)

120

Do Not Fill In
State Well No. *13N/4E-32N1#*
Other Well No. _____
Region _____

(1) Driller:
Name *Frank P. Conley*
Address *432 - Feather Rider Blvd*
Marysville, Calif
License No. *105346* Classification *C 57*

(2) Proposed use or uses (check): (3) Equipment used (check):
Domestic Municipal
Irrigation Industrial Rotary
Domestic and Irrigation Test well Cable
Other _____ Dug well
Other _____ Other _____

Owner:

Name _____
Address _____

(4) Type of work (check):
New well Reconditioning of well
Deepening existing well

(5) Well log:
Total depth of well *84* ft.

Give details of formations penetrated, such as silt, peat, muck, sand, gravel, clay, shale, sandstone, hardpan, rock. Include size of gravel (diameter) and sand (fine, medium, coarse), color of material, structure (loose, packed, cemented, soft, hard, brittle).

Depth From Ground Surface

ft.	to	ft.
4	"	5
5	"	18
18	"	22
22	"	46
46	"	50
50	"	75
75	"	84
"	"	"
"	"	"
"	"	"
"	"	"
"	"	"
"	"	"
"	"	"
"	"	"
"	"	"
"	"	"
"	"	"
"	"	"
"	"	"
"	"	"
"	"	"

top soil
hard pan
brown clay
soft brown clay
brown clay
gray sand
tough brown clay
fine brown sand

Plotted and Coded
As Well *13N 4E 32N1*

FOR OFFICIAL USE ONLY

If additional space is required, continue on DWR Form No. 246—Supplement, and attach to respective report copies.

(6) Casing left in well:

LENGTH FT.	DIAMETER INCHES	SINGLE, DOUBLE, WELDED, OTHER	LBS. PER FOOT OR GAGE OF CASING	SEATING BELOW GROUND SURFACE, FT.
<i>53</i>	<i>8"</i>	<i>welded</i>	<i>129</i>	<i>5-2 1/2</i>
_____	_____	_____	_____	_____
_____	_____	_____	_____	_____
_____	_____	_____	_____	_____

Type and size of shoe or well ring *3 X 3/8* Welded joints Yes No

51467

WATER WELL DRILLERS REPORT

(Sections 7076, 7077, 7078, Water Code)

Do Not Fill In
 State Well No. 16N/9E-26N1
 Other Well No. _____
 Region _____

(7) Perforations:

Type of perforator used _____

Perforated	ft.	to	ft.	Hole size	No. of holes
"	"	"	"	"	"
"	"	"	"	"	"
"	"	"	"	"	"
"	"	"	"	"	"
"	"	"	"	"	"
"	"	"	"	"	"
"	"	"	"	"	"
"	"	"	"	"	"
"	"	"	"	"	"
"	"	"	"	"	"

(8) Water levels:

Depth at which water first encountered 18 ft.
 Depth to water before perforating _____ ft.
 Depth to water after perforating _____ ft.
 Note any change in water level while drilling _____

(9) Well pumping test:

Date of test _____ By whom _____
 Depth to water when test started _____ ft.
 G.P.M. at beginning of test _____
 Drawdown from standing level _____ ft.
 G.P.M. at completion of test _____
 Drawdown at completion of test _____ ft.
 Length of time tested _____
 Temperature of water _____
 Was gas present in water? Yes No

(10) General:

Was well gravel packed? Yes Size of rock _____ Thickness of pack _____
 Was a surface sanitary seal provided? No
 Were any strata sealed against pollution? Yes No If yes, attach detailed description.
 Strata sealed 5 1/2 ft. sealed casing driven into solid clay
 Was analysis made of water? Yes No If yes, attach copy.
 Was electric log made of well? Yes No If yes, attach copy.
 If well abandoned, was it plugged and sealed? _____
 Method of plugging and sealing _____

FOR OFFICIAL USE ONLY

(11) Location:

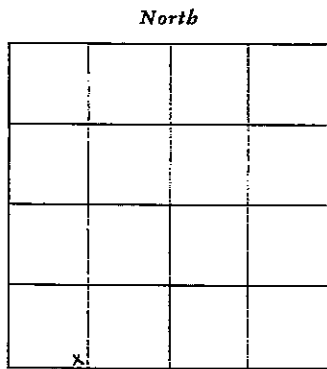

Section No. 32 (11)
 Township 13-North
 Range 4-East
 Base & Meridian N. 19
 Show location of well in Section, thus (X)
 Distances to section lines from well, N or S 75 ft. and E or W 4200 ft.
 Show location of nearest known well, thus (O)
 Distance to nearest known well _____ ft.

(12) Time of work:

Work started date Aug 8 Completed date Aug 9
 Date of this report Oct 6, 1951

WELL DRILLER'S STATEMENT:

This well was drilled under my jurisdiction and this report is true to the best of my knowledge and belief.

[SIGNED] Frank P. Conley
 Well Driller
 By Bernice Freeborn
 License No. 105346 Classification C 57
 Dated Oct 6, 1951

13N/4E-33J1

DO NOT CHECK

ORIGINAL
File Original, Duplicate and Triplicate with the
REGIONAL WATER POLLUTION
CONTROL BOARD No. 5
(insert appropriate number)

WATER WELL DRILLERS REPORT

(Sections 7076, 7077, 7078, Water Code)

STATE OF CALIFORNIA

1105

Do Not Fill In
No. 73352
State Well No. 13N/4E-33J1
Other Well No. 1105

(1) OWNER:

(2) LOCATION OF WELL:

County SUTTER Owner's number, if any— NONE
R. F. D. or Street No. 1 MILE NORTH OF NICOLAUS CROSSING
AVE. ON PACIFIC AVE. HOUSE LOCATED
50 FT. WEST OF PACIFIC AVE. - WELL
LOCATED 30 FT. NORTH WEST OF GARAGE.
(CROSSBRIDGE AREA)

(3) TYPE OF WORK (check):

New well Deepening Reconditioning Abandon
If abandonment, describe material and procedure in Item 11.

(4) PROPOSED USE (check):

Domestic Industrial Municipal
Irrigation Test Well Other

(5) EQUIPMENT:

Rotary
Cable
Dug Well

(6) CASING INSTALLED:

SINGLE DOUBLE
From 0 ft. to 100 ft. 8 Diam. 12 Gage or Wall
Diameter of Bore from ft. to ft.
NONE

Type and size of shoe or well ring 8X12X4 Size of gravel:
Describe joint BUTT WELDED

(7) PERFORATIONS:

Type of perforator used NONE
Size of perforations in., length, by in.
From ft. to ft. Perf. per row Rows per ft.

(8) CONSTRUCTION:

Was a surface sanitary seal provided? Yes No To what depth 2 FT. ft.
Were any strata sealed against pollution? Yes No If yes, note depth of strata
From 0 ft. to 100 ft.
Method of Sealing CASING DRIVEN IN CLAY

(9) WATER LEVELS:

Depth at which water was first found 65 FT. ft.
Standing level before perforating NO PERFORATING ft.
Standing level after perforating ✓ ft.

(10) WELL TESTS:

Was a pump test made? Yes No If yes, by whom?
Yield: gal./min. with ft. draw down after hrs.
Temperature of water Was a chemical analysis made? Yes No
Was electric log made of well? Yes No

(11) WELL LOG:

Total depth 155 ft. Depth of completed well 154 ft.
Formation: Describe by color, character, size of material, and structure.
0 ft. to 3 ft. TOP SOIL
3 " " 30 " RED CLAY
30 " " 32 " FINE BROWN SAND
32 " " 80 " SOFT BROWN CLAY
80 " " 96 " FINE BROWN SAND
96 " " 145 " HEAVY BROWN CLAY
145 " " 155 " BLUE CLAY & FINE SAND (BLUE)

FOR OFFICIAL USE ONLY

Work started MAY 12 1963 Completed MAY 14 1962

WELL DRILLER'S STATEMENT:
This well was drilled under my jurisdiction and this report is true to the best of my knowledge and belief.

NAME SUTTER PUMP WORKS
Address 909 S WALTON
FURB CITY CALIF.
[SIGNED] Carl J. Lamm Well Driller
License No. 154299 Dated JUNE 18, 1962

ORIGINAL

File with DWR

STATE OF CALIFORNIA

THE RESOURCES AGENCY

DEPARTMENT OF WATER RESOURCES

WATER WELL DRILLERS REPORT

Do not fill in

No. 111753

Permit No. or Date

State Well No. Other Well No. 13N/4E-33P

(2) LOCATION OF WELL (See instructions):

County Sutter Owner's Well Number Well address if different from above East Michaels Township Range Section Distance from cities, roads, railroads, fences, etc. 1300' N of Cornelius Rd 1800' East of Hwy 70

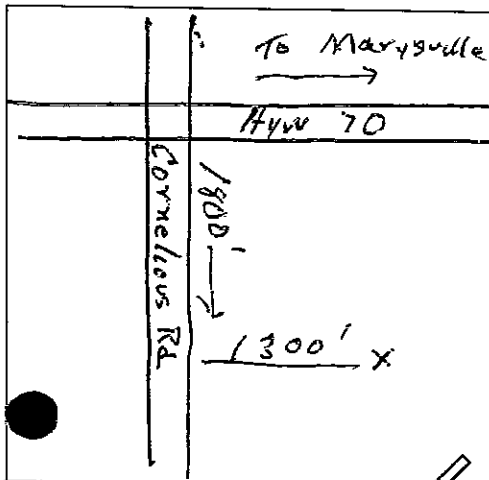

WELL LOCATION SKETCH

(3) TYPE OF WORK:

- New Well [checked] Deepening [] Reconstruction [] Reconditioning [] Horizontal Well [] Destruction [] (Describe destruction materials and procedures in Item 12) (4) PROPOSED USE: Domestic [] Irrigation [checked] Industrial [] Test Well [] Stock [] Municipal [] Other []

(12) WELL LOG: Total depth 336 ft. Depth of completed well 336 ft. from ft. to ft. Formation (Describe by color, character, size or material)

0 - 3 - Soil 3 - 87 - Br Clay 87 - 98 - Fine Gravel 98 - 140 - Br Clay 140 - 150 - Cem Sand & gravel 2" 150 - 205 - Br Clay 205 - 210 - Cem gravel Fine 210 - 260 - Blue Clay 260 - 268 - Cem Bl Sand 268 - 310 - Blue Clay 310 - 336 - Blue Cem Sand covering

- (5) EQUIPMENT: Rotary [] Cable [checked] Other [] Reverse [] Air [] Bucket []

- (6) GRAVEL PACK: Yes [] No [checked] Size Diameter of bore Packed from to

- (7) CASING INSTALLED: Steel [checked] Plastic [] Concrete []

- (8) PERFORATIONS: Type of perforation or size of screen

Table with columns: From ft., To ft., Dia. in., Gage or Wall, From ft., To ft., Slot size. Row 1: 0, 152, 4, 10, , ,

(9) WELL SEAL:

Was surface sanitary seal provided? Yes [] No [checked] If yes, to depth ft. Were strata sealed against pollution? Yes [checked] No [] Interval 0-152 ft. Method of sealing Casings landed in clay

Work started 9/5/1978 Completed 9/12/1978

(10) WATER LEVELS:

Depth of first water, if known 60 ft. Standing level after well completion ft.

WELL DRILLER'S STATEMENT:

This well was drilled under my jurisdiction and this report is true to the best of my knowledge and belief.

(11) WELL TESTS:

Was well test made? Yes [] No [checked] If yes, by whom? Type of test Pump [] Bailer [] Air lift [] Depth to water at start of test ft. At end of test ft. Discharge gal/min after hours Water temperature

SIGNED Henry J. Terry (Well Driller) NAME H.T. Terry (Person, firm, or corporation) (Typed or printed) Address 2410 Tuscan Rd City Yuba City Zip 95991 License No. 209184 Date of this report 7/20/78

127

ORIGINAL

File Original, Duplicate and Triplicate with the DIVISION OF WATER RESOURCES

P. O. BOX 1079 SACRAMENTO 5, CALIFORNIA

STATE OF CALIFORNIA DEPARTMENT OF PUBLIC WORKS

DIVISION OF WATER RESOURCES

51-793

NET 1

Do Not Fill In

State Well No. 13N-4E-33Q1
Other Well No. 27-27A
Region 5

WATER WELL DRILLERS REPORT

(Sections 7076, 7077, 7078, Water Code)

17

(1) Driller: Name William Flynn
Address Box 157 Sutter, Calif.
License No. 97194 Classification SC 57

(2) Proposed use or uses (check): (3) Equipment used
Domestic [] Municipal [] (check):
Irrigation [x] Industrial [] Rotary []
Domestic and Test well [] Cable [x]
Irrigation [] Dug well []
Other [] Other []

Owner: Name Address

(4) Type of work (check):
New well [x] Reconditioning of well []
Deepening existing well []

(5) Well log:

Total depth of well 300 ft.

Give details of formations penetrated, such as silt, peat, muck, sand, gravel, clay, shale, sandstone, hardpan, rock. Include size of gravel (diameter) and sand (fine, medium, coarse), color of material, structure (loose, packed, cemented, soft, hard, brittle).

Table with 2 columns: Depth From Ground Surface and Formation Description. Includes entries like Top Soil, Yellow Clay, Sand and Decomposed Granite, etc.

Plotted and Coded
As Well 13N-4E-33Q1

FOR OFFICIAL USE ONLY

If additional space is required, continue on DWR Form No. 246—Supplement, and attach to respective report copies.

(6) Casing left in well:

Table with 5 columns: LENGTH FT., DIAMETER INCHES, SINGLE, DOUBLE, WELDED, OTHER, LBS. PER FOOT OR GAGE OF CASING Steel, SEATING BELOW GROUND SURFACE, FT.

Type and size of shoe or well ring Welded joints [x] Yes [] No

14" X 5/8" X 4"

27-27A 51-793

WATER WELL DRILLERS REPORT

(Sections 7076, 7077, 7078, Water Code)

Do Not Fill In
State Well No. 13A-4E-33Q1
Other Well No. 27-27A
Region 5

(7) Perforations:

Type of perforator used None

Perforated	ft.	to	ft.	Hole size	No. of holes
"	"	"	"	"	"
"	"	"	"	"	"
"	"	"	"	"	"
"	"	"	"	"	"
"	"	"	"	"	"
"	"	"	"	"	"
"	"	"	"	"	"
"	"	"	"	"	"
"	"	"	"	"	"
"	"	"	"	"	"

(8) Water levels:

Depth at which water first encountered 40 ft.
Depth to water before perforating _____ ft.
Depth to water after perforating _____ ft.
Note any change in water level while drilling _____

(9) Well pumping test:

Date of test _____ By whom _____
Depth to water when test started _____ ft.
G.P.M. at beginning of test _____
Drawdown from standing level 10 ft.
G.P.M. at completion of test _____
Drawdown at completion of test _____ ft.
Length of time tested _____
Temperature of water _____
Was gas present in water? Yes No

(10) General:

Was well gravel packed? NO Size of rock _____ Thickness of pack _____
Was a surface sanitary seal provided? _____
Were any strata sealed against pollution? Yes No If yes, attach detailed description.
Strata sealed _____
Was analysis made of water? Yes No If yes, attach copy.
Was electric log made of well? NO Yes No If yes, attach copy.
If well abandoned, was it plugged and sealed? _____
Method of plugging and sealing _____

FOR OFFICIAL USE ONLY

(11) Location:

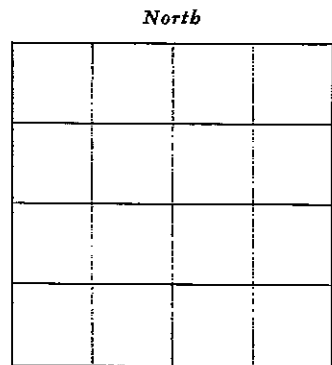

Section No. 33
Township Nicolas
Range Sutter County
Base & Meridian _____
Show location of well in Section, thus (X)
Distances to section lines from well, N or S 500 N ft. and E or W _____ ft.
Show location of nearest known well, thus (O)
Distance to nearest known well 500 ft.

(12) Time of work:

Work started date June 5 Completed date June 8 51
Date of this report June 25 51

WELL DRILLER'S STATEMENT:

This well was drilled under my jurisdiction and this report is true to the best of my knowledge and belief.

[SIGNED] [Signature]
Well Driller

By _____
License No. 97194 Classification 3057
Dated June 25, 1951

1-Mile North & 1-Mile East of East Nicolas, 500 ft North of Road

(11) WELL LOG:

Total depth 130 ft. Depth of completed well 130 ft.

Formation: Describe by color, character, size of material, and structure

0 ft. to 2 Top soil ft.
2 35 Soft Clay
25 35 Dry Sand
35 60 soft yellow clay
60 78 sand & gravel
78 - 125 yellow clay
125 - 130 sand.

(2) LOCATION OF WELL:

County Butte Owner's number, if any _____
Township, Range, and Section _____
Distance from cities, roads, railroads, etc. _____

(3) TYPE OF WORK (check):

New Well Deepening Reconditioning Destroying

If destruction, describe material and procedure in Item 11.

(4) PROPOSED USE (check):

Domestic Industrial Municipal
Irrigation Test Well Other

(5) EQUIPMENT:

Rotary
Cable
Other

This Well is approx 2 miles
south of Rio Chino on
Highway Ave. approx 1/2 mi.
East out in Pasture.

(6) CASING INSTALLED:

STEEL: OTHER:
SINGLE DOUBLE

If gravel packed

From ft.	To ft.	Diam.	Gage or Wall	Diameter of Bore	From ft.	To ft.
0	80	8"	12ga.			

Size of shoe or well gage 4x4x8" Size of gravel: _____

Describe joints B/W

Plotted and Coded

As Well 13N/4E-34M SC

(7) PERFORATIONS OR SCREEN:

Type of perforation or name of screen

From ft.	To ft.	Perf. per row	Rows per ft.	Size in. x in.

(8) CONSTRUCTION:

Was a surface sanitary seal provided? Yes No To what depth _____ ft.

Were any strata sealed against pollution? Yes No If yes, note depth of strata

From 0 ft. to _____ ft.

From _____ ft. to _____ ft.

Method of sealing _____

Work started 4/5 1971 . Completed 4/6 1971

WELL DRILLER'S STATEMENT:

This well was drilled under my jurisdiction and this report is true to the best of my knowledge and belief.

(9) WATER LEVELS:

Depth at which water was first found, if known 35 ft.

Standing level before perforating, if known _____ ft.

Standing level after perforating and developing 15.5 ft.

NAME Desman Don Pump Co.
(Person, firm, or corporation) (Typed or printed)

Address 470 N. Los Hach Blvd
Huba City Calif.

(10) WELL TESTS:

Was pump test made? Yes No If yes, by whom?

Field: _____ gal./min. with _____ ft. drawdown after _____ hrs.

Temperature of water _____ Was a chemical analysis made? Yes No

Was electric log made of well? Yes No If yes, attach copy

[SIGNED] J. N. Desman
(Well Driller)

License No. 196093 Dated 4/13 1971

SKETCH LOCATION OF WELL ON REVERSE SIDE

CONFIDENTIAL LOG
Water Code Sec. 13752

DIVISION OF WATER RESOURCES

WATER WELL DRILLERS REPORT

(Sections 7076, 7077, 7078, State Code)

Do Not Fill In

State Well No. _____
Other Well No. 13N-4E-35H
Region 5

206

(1) Driller: Chas D. Cronin
Name _____
Address #14405 1/2 St. Colton
License No. 123196 Classification C-57
Proposed use or uses (check):
Domestic Municipal
Irrigation Industrial
Domestic and Irrigation Test well
Other _____
(3) Equipment used (check):
Rotary
Cable
Dug well
Other _____

Owr _____
Name _____
Addr _____

(4) Type of work (check):
New well Reconditioning of well
Deepening existing well

(5) Well log:
Total depth of well 544 ft.

Give details of formations penetrated, such as silt, peat, muck, sand, gravel, clay, shale, sandstone, hardpan, rock. Include size of gravel (diameter) and sand (fine, medium, coarse), color of material, structure (loose, packed, cemented, soft, hard, brittle).

Depth From Ground Surface

ft.	to	ft.	
0		372	UNKNOWN
372		382	Gray Sand (med)
382		510	Beam & clean out - Clay mud
510		544	Block Sand Cemented (Coarse)
			Plotted and Coded
			As Well <u>13N 19E 35H80</u>

FOR OFFICIAL USE ONLY

If additional space is required, continue on DWR Form No. 246—Supplement, and attach to respective report copies.

(6) Casing left in well:

LENGTH FT.	DIAMETER INCHES	SINGLE, DOUBLE, WELDED, OTHER	LBS. PER FOOT OR GAGE OF CASING	SEATING BELOW GROUND SURFACE, FT.
60	12	Single Welded	129.2	360 to 390

Type and size of shoe or well ring _____ Welded joints Yes No

2-12x4x3/8 Steel shoes

51-469 SHEET 2 106
Sutter
Do Not Fill In
State Well No. _____
Other Well No. 13N-4E-35
Region 5

WATER WELL DRILLERS REPORT
(Sections 7076, 7077, 7078, Water Code)

CONFIDENTIAL
Section 7076, Water Code

(7) Perforations:

Type of perforator used	Perforated	ft. to	ft. Hole size	No. of holes
TORC	Top 30'	Slotted 6"	8" slots to the round	
"	"	"	"	"
"	"	"	"	"
"	"	"	"	"
"	"	"	"	"
"	"	"	"	"
"	"	"	"	"
"	"	"	"	"
"	"	"	"	"
"	"	"	"	"

(8) Water levels:

Depth at which water first encountered 28 ft.
Depth to water before perforating _____ ft.
Depth to water after perforating _____ ft.
Note any change in water level while drilling
None

(9) Well pumping test:

Date of test _____ By whom _____
Depth to water when test started _____ ft.
G.P.M. at beginning of test _____
Drawdown from standing level _____ ft.
G.P.M. at completion of test _____
Drawdown at completion of test _____ ft.
Length of time tested _____
Temperature of water _____
Was gas present in water? Yes No

(10) General:

Was well gravel packed? No Size of rock _____ Thickness of pack _____
Was a surface sanitary seal provided? _____
Were any strata sealed against pollution? Yes No If yes, attach detailed description.
Strata sealed _____
Was analysis made of water? Yes No If yes, attach copy.
Was electric log made of well? Yes No If yes, attach copy.
If well abandoned, was it plugged and sealed? _____
Method of plugging and sealing _____

FOR OFFICIAL USE ONLY

(11) Location:

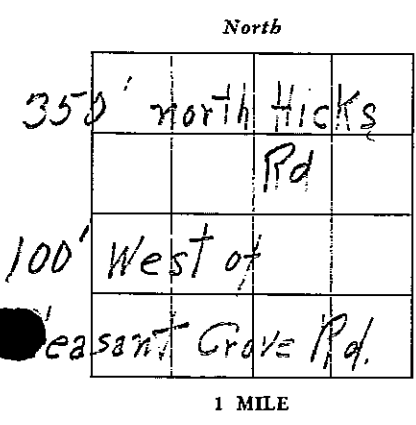

Section No. _____
Township _____
Range _____
Base & Meridian _____
Show location of well in Section, thus (X) _____
Distances to section lines from well, N or S _____ ft. and E or W _____ ft.
Show location of nearest known well, thus (O) _____
Distance to nearest known well _____ ft.

(12) Time of work:

Work started date 4/20/53 Completed date 4/24/53
Date of this report 5/18/53

WELL DRILLER'S STATEMENT:
This well was drilled under my jurisdiction and this report is true to the best of my knowledge and belief.
[SIGNED] Chas D. Sandell
Well Driller
By _____
License No. 12319 Classification 357
Dated May 18, 1953

ORIGINAL
 File Original, Duplicate and Triplicate with the
 REGIONAL WATER POLLUTION
 CONTROL BOARD No. _____
 (Insert appropriate number)

WATER WELL DRILLERS REPORT

(Sections 7076, 7077, 7078, Water Code)

STATE OF CALIFORNIA

256

Do Not Fill In
No. 8627
 State Well No. _____
 Other Well No. 13/4-36F

(1) Nam _____
Addr _____

(2) LOCATION OF WELL:
 County Sutter Owner's number, if any—
 R. F. D. or Street No. Rio Oso Sub Station
1/2 mile East of Pleasant Grove Road
on Nicks Road, 1/2 mile North of Nicks Road

(3) TYPE OF WORK (check):
 New well Deepening Reconditioning Abandon
 If abandonment, describe material and procedure in Item 11.

(4) PROPOSED USE (check):
 Domestic Industrial Municipal
 Irrigation Test Well Other

(5) EQUIPMENT:
 Rotary
 Cable
 Dug Well

(6) CASING INSTALLED:
 SINGLE DOUBLE
 From 0 ft. to 91 ft. 8" Diam. 8 Gage or Wall
 Diameter of Bore from ft. to ft.
 Type and size of shoe or well ring 8" x 4" x 5/8" Size of gravel:
 Describe joint _____

(7) PERFORATIONS: None
 Type of perforator used _____
 Size of perforations in., length, by in.
 From ft. to ft. Perf. per row Rows per ft.

(8) CONSTRUCTION:
 Was a surface sanitary seal provided? Yes No To what depth 6 ft.
 Were any strata sealed against pollution? Yes No If yes, note depth of strata
 From ft. to ft.
 Method of Sealing _____

(9) WATER LEVELS:
 Depth at which water was first found 45 ft.
 Standing level before perforating _____ ft.
 Standing level after perforating _____ ft.

(10) WELL TESTS:
 Was a pump test made? Yes No If yes, by whom? SWD & P Co.
 Yield: 120 gal./min. with 12 ft. draw down after 8 hrs.
 Temperature of water _____ Was a chemical analysis made? Yes No
 Was electric log made of well? Yes No

(11) WELL LOG:

Total depth	ft.	Depth of completed well	ft.
0	to	2	Sand
2		12	Red Clay
12		21	brown sandy clay
21		56	sand & gravel
56		59	brown sandy clay
59		67	sand & gravel
67		78	brown sandy clay
78		82	cemented sand
82		95	brown sandy clay
95		108	cemented sand
108		110	sand & pea gravel
110		150	brown sandy clay

Formation: Describe by color, character, size of material, and structure.

Plotted and Coded
 As Well 13/4-14F-36F50

FOR OFFICIAL USE ONLY

Work started 6/29/54 19 _____ Completed 7/7/54 19 _____

WELL DRILLER'S STATEMENT:
 This well was drilled under my jurisdiction and this report is true to the best of my knowledge and belief.
 NAME Star Well Drilling & Pump Co.
 (Person, firm, or corporation) (Typed or printed)
 Address P.O. Box 689
Yuba City, Calif.
 [SIGNED] Stem & Mares
 Well Driller
 License No. 121868 Dated 7/10/54, 19 _____

51-471

WATER WELL DRILLERS REPORT

(Sections 7076, 7077, 7078, Water Code)

LOCATION NOT CHECKED
Do Not Fill In

STATE OF CALIFORNIA—DEPARTMENT OF PUBLIC WORKS
 DIVISION OF WATER RESOURCES
 SECTION 7076
 C.O.M.E.I.D.E.
 WATER CODE

STATE OF CALIFORNIA—DEPARTMENT OF PUBLIC WORKS
DIVISION OF WATER RESOURCES

State Well No. _____
Other Well No. 13N-4E-36N
Region _____

(1) DRILLER: (person, firm, or corporation)

Name Frank P. Conley
Address 432 - Feather River Blvd
Marysville, Calif

(8) LOCATION OF WELL:

County Sutter
R. F. D. or Street No. Pleasant Grove Rd,
End of Cornelius Ave.

OWNER

Name _____
Address _____

(9) WELL LOG:

Total depth of well 320 ft.

Formation: Mention size of water gravel—

0	ft. to	28	ft.	top soil
28	48			orange sand
48	50			sea gravel
50	190			brown clay
190	193			brown sand
193	198			crumbly brown clay
198	200			sea gravel
200	260			brown clay & gravel
260	265			blue clay
265	295			brown clay
295	319			blue shale
319	320			clay

(2) Proposed Use (Check)

Domestic	<input type="checkbox"/>	Industrial	<input type="checkbox"/>	Rotary	<input type="checkbox"/>
Irrigation	<input checked="" type="checkbox"/>	Test Well	<input type="checkbox"/>	Cable	<input checked="" type="checkbox"/>
Municipal	<input type="checkbox"/>	Other	<input type="checkbox"/>	Dug Well	<input type="checkbox"/>
				Other	<input type="checkbox"/>

Equipment

(3) CASING:

84	ft. of	14	in	10	lb./sq. casing	left in well
"	"	"	"	"	"	"
"	"	"	"	"	"	"
"	"	"	"	"	"	"

Type and size of shoe or well ring 14" 4 X 1/2

(4) PERFORATIONS:

Type of perforator used _____

Perforated	ft. to	ft.	holes per	in.
"	"	"	"	"
"	"	"	"	"
"	"	"	"	"
"	"	"	"	"
"	"	"	"	"
"	"	"	"	"
"	"	"	"	"
"	"	"	"	"
"	"	"	"	"
"	"	"	"	"
"	"	"	"	"
"	"	"	"	"

Diameter of perforations _____ in., length _____ in.

(5) WATER LEVELS:

Was electric log made of well? Yes No If yes, attach copy.
 Depth at which water was first found 50 ft.
 Standing level before perforating _____ ft.
 Standing level after perforating _____ ft.
 Note your observation of any change in water level while drilling 40
 Was a surface sanitary seal provided? No

(6) WELL PUMPING TEST:

Capacity _____ gal./min. ft. draw down _____
 Was well gravel packed? No
 Were any strata sealed against pollution? Casing driven into clay at 80
 Temperature _____ Was a chemical analysis made? _____ Attach copy _____
 If abandoned was well capped? _____

(7) TYPE OF WORK (check):

New well Reconditioning of well
 Deepening existing well

Plotted and Coded
 As Well 13N 4E 36N 80

FOR OFFICIAL USE ONLY

Work started July 3 19 53, Completed July 10 19 53
 Date of Report Aug 7, 19 53

WELL DRILLER'S STATEMENT:

This well was drilled under my jurisdiction and this report is true to the best of my knowledge and belief.

[SIGNED] Frank P. Conley
 Well Driller

By Bernice Schabert
 License No. 14524 Classification 357

Dated Aug 7, 19 53

WATER WELL DRILLERS REPORT

(Sections 7076, 7077, 7078, Water Code)

LOCATION NOT CHECKED
Do Not Fill In

STATE OF CALIFORNIA—DEPARTMENT OF PUBLIC WORKS
DIVISION OF WATER RESOURCES 229

State Well No. _____
Other Well No. 13N-4E-36C
Region _____

(1) DRILLER: (person, firm, or corporation)
Name Frank P. Conley
Address 432 - Mendocino Rd. - Marysville

(8) LOCATION OF WELL:
County Sutter
R. F. D. or Street No. 1/2 mile south of
Hicks Rd. near drain
ditch - 1/2 mile east
of Pleasant Grove Rd.
east of Gallagher home.

(2) Proposed Use (Check) Equipment

Domestic	<input type="checkbox"/>	Industrial	<input type="checkbox"/>	Rotary	<input type="checkbox"/>
Irrigation	<input checked="" type="checkbox"/>	Test Well	<input type="checkbox"/>	Cable	<input checked="" type="checkbox"/>
Municipal	<input type="checkbox"/>	Other	<input type="checkbox"/>	Dug Well	<input type="checkbox"/>
				Other	<input type="checkbox"/>

(9) WELL LOG:
Total depth of well 255 ft.

Formation: Mention size of water gravel—

0	ft. to	6	ft.	to soil
6	"	30	"	gravel
30	"	90	"	silty clay
90	"	105	"	sand
105	"	200	"	brown clay
200	"	205	"	gravel
205	"	240	"	fine clay
240	"	255	"	fine sand

(3) CASING:
108 ft. of 14 in 10 lb./ga. casing 107 1/2 left in well

Type and size of shoe or well ring 14" 4X 1/2

(4) PERFORATIONS:

Perforated	ft. to	ft.	holes per	in.
"	"	"	"	"
"	"	"	"	"
"	"	"	"	"
"	"	"	"	"
"	"	"	"	"
"	"	"	"	"
"	"	"	"	"
"	"	"	"	"
"	"	"	"	"

Diameter of perforations in., length in.

(5) WATER LEVELS:

Was electric log made of well? Yes No If yes, attach copy.

Depth at which water was first found 28 ft.

Standing level before perforating _____ ft.

Standing level after perforating _____ ft.

Note your observation of any change in water level while drilling _____

Was a surface sanitary seal provided? No

(6) WELL PUMPING TEST: Tested by Rudolf Pump Co. Woodland

Capacity _____ gal./min. ft. draw down _____

Was well gravel packed? No

Were any strata sealed against pollution? _____

Temperature _____ Was a chemical analysis made? _____ Attach copy _____

If abandoned was well capped? _____

(7) TYPE OF WORK (check):

New well Reconditioning of well

Deepening existing well

Plotted and Ceded
As Well 13N-4E-36C

FOR OFFICIAL USE ONLY

Work started Mar. 6 19 53. Completed Mar. 16 19 53
Date of Report July. 23 19 53

WELL DRILLER'S STATEMENT:
This well was drilled under my jurisdiction and this report is true to the best of my knowledge and belief.

[SIGNED] Frank P. Conley
Well Driller

By Bernice Freeborn
License No. 105346 Classification C 57

Date July 23 19 53

STATE OF CALIFORNIA
DEPARTMENT OF PUBLIC WORKS
DIVISION OF WATER RESOURCES

45
SHEET 1
LOCAT 31-113 ECKED

WATER WELL DRILLERS REPORT

(Sections 7076, 7077, 7078, Water Code)

Do Not Fill In
State Well No. _____
Other Well No. 13N-5-270
Region _____

(1) Driller:
Name William Flynn
Address Box 157 Sutter, Calif.
License No. 97194 Classification 8057

(2) Proposed use or uses (check): (3) Equipment used (check):
Domestic Municipal
Irrigation Industrial Rotary
Domestic and Test well Cable
Irrigation Dug well
Other _____ Other _____

(4) Type of work (check):
New well Reconditioning of well
Deepening existing well

(5) Well log:
Total depth of well 400 ft.

Give details of formations penetrated, such as silt, peat, muck, sand, gravel, clay, shale, sandstone, hardpan, rock. Include size of gravel (diameter) and sand (fine, medium, coarse), color of material, structure (loose, packed, cemented, soft, hard, brittle).

Depth From Ground Surface

1	ft. to	3	ft.
3	" "	10	" "
10	" "	35	" "
35	" "	40	" "
40	" "	55	" "
55	" "	58	" "
58	" "	85	" "
85	" "	100	" "
100	" "	110	" "
110	" "	120	" "
120	" "	170	" "
170	" "	180	" "
180	" "	190	" "
190	" "	200	" "
200	" "	250	" "
250	" "	290	" "
290	" "	300	" "
300	" "	360	" "
360	" "	370	" "
370	" "	400	" "
400	" "	405	" "
405	" "		" "
	" "		" "
	" "		" "
	" "		" "

top soil
hard pan
brown clay
brown clay
yellow clay
packed gravel
soft clay
brown clay
yellow hard clay
soft yellow clay
hard gray clay
soft clay
yellow clay
hard sand
tough clay
gray clay
hard sand
yellow clay
blue clay
hard gray clay
blue sand
blue shale

Plotted and Coded
As Well 13N 105E-270

FOR OFFICIAL USE ONLY

CONFIDENTIAL
Section 7076.1, Water Code

If additional space is required, continue on DWR Form No. 246—Supplement, and attach to respective report copies.

(6) Casing left in well:

LENGTH FT.	DIAMETER INCHES	SINGLE, DOUBLE, WELDED, OTHER	LBS. PER FOOT OR GAGE OF CASING	SEATING BELOW GROUND SURFACE, FT.
132	14	single	107	132

Type and size of shoe or well ring _____ Welded joints— Yes No
14" x 5/8" x 4"

91-113 45
 SHEET 2
 LOCATION NOT CHECKED
 LOCATION NOT CHECKED
 Do Not Fill In

WATER WELL DRILLERS REPORT

(Sections 7076, 7077, 7078, Water Code)

State Well No. _____
 Other Well No. _____
 Region _____

(7) Perforations:

Type of perforator used	Mills	ft.	to	ft.	Hole size	No. of holes
Perforated	90		124		1/2 X 2	180
"	"	"	"	"	"	"
"	"	"	"	"	"	"
"	"	"	"	"	"	"
"	"	"	"	"	"	"
"	"	"	"	"	"	"
"	"	"	"	"	"	"
"	"	"	"	"	"	"
"	"	"	"	"	"	"
"	"	"	"	"	"	"

(8) Water levels:

Depth at which water first encountered 40 ft.
 Depth to water before perforating 40 ft.
 Depth to water after perforating 40 ft.
 Note any change in water level while drilling _____

(9) Well pumping test:

Date of test None By whom _____
 Depth to water when test started _____ ft.
 G.P.M. at beginning of test _____
 Drawdown from standing level _____ ft.
 G.P.M. at completion of test _____
 Drawdown at completion of test _____ ft.
 Length of time tested _____
 Temperature of water _____
 Was gas present in water? Yes No

(10) General:

Was well gravel packed? NO Size of rock _____ Thickness of pack _____ **FOR OFFICIAL USE ONLY**
 Was a surface sanitary seal provided? _____
 Were any strata sealed against pollution? Yes No If yes, attach detailed description.
 Strata sealed _____
 Was analysis made of water? Yes No If yes, attach copy.
 Was electric log made of well? Yes No If yes, attach copy.
 If well abandoned, was it plugged and sealed? _____
 Method of plugging and sealing _____

C O N F I D E N T I A L
 Section 7076.1, Water Code

(11) Location:

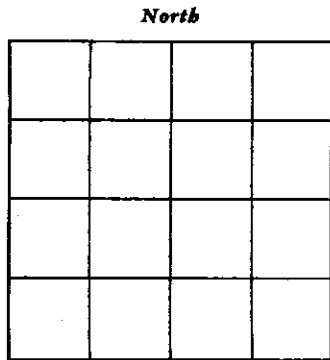

1 MILE

Section No. 27
 Township 10 / 12
 Range Placer County
 Base & Meridian _____
 Show location of well in Section, thus (X) _____
 Distances to section lines from well, N or S _____ ft.
 and E or W _____ ft.
 Show location of nearest known well, thus (O) _____
 Distance to nearest known well 1800 ft.

(12) Time of work:

Work started date 11/30/51 Completed date 12/5/51
 Date of this report 3/3/52

WELL DRILLER'S STATEMENT:

This well was drilled under my jurisdiction and this report is true to the best of my knowledge and belief.

[SIGNED] [Signature]
 W/Driller

By _____
 License No. 97194 Classification 8057

Dated March 3, 1952

3rd road south of Sheridan on old Resville road 1 1/2 miles west of old Resville road, 1/4 mile past 1st set of buildings, 800 ft. north of road.

ORIGINAL

File with DWR

Notice of Intent No. 135681

Local Permit No. or Date _____

STATE OF CALIFORNIA
THE RESOURCES AGENCY
DEPARTMENT OF WATER RESOURCES
WATER WELL DRILLERS REPORT

Do not fill in

No. 44513

State Well No. _____
Other Well No. 13N/5E-28L

(2) LOCATION OF WELL (See instructions):
County Sutter Owner's Well Number _____
Well address if different from above Waltz Rd
Township 13N Range 5E Section 28
Distance from cities, roads, railroads, fences, etc. N/E quarter of
s/w quarter of section 28 1 1/2 miles
East of Brewer Rd and 1/2 mile
north of Waltz Rd.

(3) TYPE OF WORK:
New Well Deepening
Reconstruction
Reconditioning
Horizontal Well
Destruction (Describe destruction materials and procedures in Item 12)
(4) PROPOSED USE:
Domestic
Irrigation
Industrial
Test Well
Stock
Municipal
Other

(5) EQUIPMENT:
Rotary Reverse
Cable Air
Other Bucket

(6) GRAVEL PACK:
Yes No Size _____
Diameter of bore _____
Packed from _____ ft. to _____ ft.

(7) CASING INSTALLED:
Steel Plastic Concrete

(8) PERFORATIONS:
Type of perforation or size of screen Mils knife

From ft.	To ft.	Dia. in.	Gage or Wall	From ft.	To ft.	Slot size
0	204	1 1/2	3/16	130	190	

(9) WELL SEAL:
Was surface sanitary seal provided? Yes No If yes, to depth _____ ft.
Were strata sealed against pollution? Yes No Interval _____ ft.
Method of sealing Casing driven 51' into light brown clay

(10) WATER LEVELS:
Depth of first water, if known _____ ft.
Standing level after well completion 72 ft.

(11) WELL TESTS:
Was well test made? Yes No If yes, by whom? Valley Pump
Type of test Pump Bailer Air lift
Depth to water at start of test 67 ft. At end of test 136 ft.
Discharged 2950 gal/min after 2 1/2 hours Water temperature _____
Chemical analysis made? Yes No If yes, by whom? _____
Well log made? Yes No If yes, attach copy to this report

(12) WELL LOG: Total depth 515 ft. Depth of completed well _____ ft.
from ft. to ft. Formation (Describe by color, character, size or material)

0	4	top soil
4	6	red clay
6	37	Brown clay
37	91	Dark Brown clay
91	93	quick sand
93	159	Cemented sand
159	220	light brown clay
220	225	black sand
225	250	Cemented gravel
250	296	Brown clay
296	331	unders & gravel
331	465	blue clay
465	490	blue shale
490	515	blue clay

ORIGINAL

File with DWR

STATE OF CALIFORNIA

THE RESOURCES AGENCY

DEPARTMENT OF WATER RESOURCES

WATER WELL DRILLERS REPORT

Do not fill in

No. 123431

of Intent No. _____

Permit No. or Date _____

State Well No. _____
Other Well No. 13U/SE-29 R

(1) Adc _____
City _____

(2) LOCATION OF WELL (See instructions):
County Sutter Owner's Well Number A-14

Well address if different from above _____
Township 13 N Range 5E Section SW 1/4 28

Distance from cities, roads, railroads, fences, etc. Approx 1 mi east
of Brewer Rd on north side of Waltz
Rd.

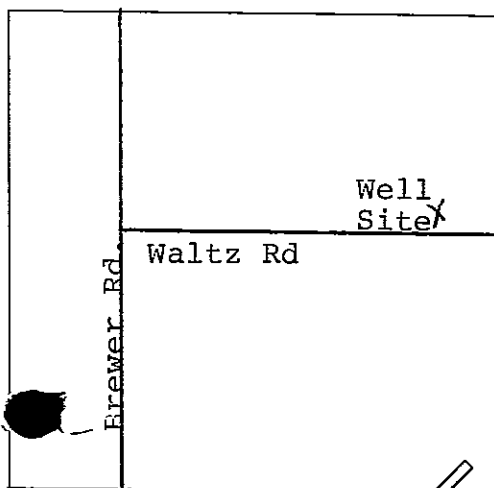

(3) TYPE OF WORK:

- New Well Deepening
- Reconstruction
- Reconditioning
- Horizontal Well
- Destruction (Describe destruction materials and procedures in Item 12)

(4) PROPOSED USE:

- Domestic
- Irrigation
- Industrial
- Test Well
- Stock
- Municipal
- Other

(12) WELL LOG: Total depth 505 ft. Depth of completed well 386 ft.
from ft. to ft. Formation (Describe by color, character, size or material)

- 0- 2 Red gravel, top soil
- 2- 7 Hard pan
- 7- 9 Gravel and clay mixed
- 9- 14 Hard yellow clay
- 14- 31 Rocks and gravel
- 31- 40 Hard yellow clay
- 40- 52 Hard pan
- 52- 54 Coarse sand and gravel
- 54- 65 Hard yellow clay
- 65- 86 Brittle brown clay
- 86- 89 Coarse sand and gravel
- 89- 96 Yellow clay
- 96- 99 Hard gray clay
- 99- 137 Brown sandy clay
- 137- 143 Coarse sand and gravel
- 143- 152 Sandy brown clay
- 152- 173 Green clay
- 173- 180 Blue clay
- 180- 190 Blue clay
- 190- 239 Hard brown clay & cemented sand
- 239- 267 Hard green clay
- 267- 280 Brown cemented sand
- 280- 285 Hard sand and brown hard pan
- 285- 320 Hard shale and sandstone
- 320- 340 Coarse sand and gravel shale
- 340- 345 Hard sandy blue clay
- 345- 350 Hard blue sand stone
- 350- 370 Hard blue clay
- 370- 377 Coarse sand and fine shale
- 377- 400 Sandy blue clay & blue shale
- 400- 441 Blue clay
- 441- 444 Clay and gravel mixed
- 444- 498 Coarse sand
- 498- 500 Sandy blue clay
- 500- 504 Clay and coarse sand
- 504- 505 Hard blue clay

WELL LOCATION SKETCH

(5) EQUIPMENT:

- Rotary Reverse
- Cable Air
- Other Bucket

(6) GRAVEL PACK:

- Yes No Size 26
- Diameter of bore 26
- Packed from 0 to 386 ft.

(7) CASING INSTALLED:

- Steel Plastic Concrete

From ft.	To ft.	Dia. in.	Gage or Wall
0	233	16	1/4
253	278	16	
338	368	16	

(8) PERFORATIONS: Johnson Irrigator

From ft.	To ft.	Slot size
233	253	100
278	338	100
368	386	100

(9) WELL SEAL:

- Was surface sanitary seal provided? Yes No If yes, to depth _____ ft.
- Were strata sealed against pollution? Yes No Interval _____ ft.
- Method of sealing _____

(10) WATER LEVELS:

Depth of first water, if known _____ ft.
Standing level after well completion 46 ft.

(11) WELL TESTS:

- Was well test made? Yes No If yes, by whom? EELCO
- Type of test Pump Bailer Air lift
- Depth to water at start of test 52 ft. At end of test 189 ft.
- Discharge 3000 gal/min after 2 hours Water temperature _____
- Analysis made? Yes No If yes, by whom? _____
- Was electric log made? Yes No If yes, attach copy to this report

Work started 2-22 19 77 Completed 2-26 19 77

WELL DRILLER'S STATEMENT:

This well was drilled under my jurisdiction and this report is true to the best of my knowledge and belief.

SIGNED _____ (Well Driller)

NAME E.E. Luhdorff Co/Division of Layne
(Person, firm, or corporation) (Typed or printed)

Address P.O. Box 1326 Western

City Woodland Zip 95695

License No. 334205 Date of this report 12-22-77

51-123

Do Not Fill In

Well No. 13N 32C1

WATER WELL DRILLERS REPORT

(Sections 7076, 7077, 7078, Water Code)

37

Other Well No. _____
Region _____

(1) Driller:

Name J. B. Breazeale
Address Route 1 Box 312 Sutter, Calif.
License No. _____ Classification _____

(2) Proposed use or uses (check):

Domestic
Irrigation
Domestic and Irrigation
Other _____

(3) Equipment used (check):

Municipal
Industrial
Test well
Rotary
Cable
Dug well
Other _____

Own Name _____
Address _____

Type of work (check):

New well Reconditioning of well
Deepening existing well

(5) Well log:

Total depth of well 120 ft.

Depth From Ground Surface

Give details of formations penetrated, such as silt, peat, muck, sand, gravel, clay, shale, sandstone, hardpan, rock. Include size of gravel (diameter) and sand (fine, medium, coarse), color of material, structure (loose, packed, cemented, soft, hard, brittle).

1	ft. to	30	ft.
30	" "	32	" "
32	" "	60	" "
60	" "	61	" "
61	" "	109	" "
109	" "	120	" "
"	" "	"	" "
"	" "	"	" "
"	" "	"	" "
"	" "	"	" "
"	" "	"	" "
"	" "	"	" "
"	" "	"	" "
"	" "	"	" "
"	" "	"	" "
"	" "	"	" "
"	" "	"	" "
"	" "	"	" "
"	" "	"	" "
"	" "	"	" "
"	" "	"	" "

Clay - red
gravel size of an egg (no water)
Clay - red
Coarse grey sand. (loose)
Clay, red
sands, grey, coarse, (loose)

Slotted and Cased

As Well 13N 32C1

FOR OFFICIAL USE ONLY

If additional space is required, continue on DWR Form No. 246—Supplement, and attach to respective report copies.

(6) Casing left in well:

LENGTH FT.	DIAMETER INCHES	SINGLE. DOUBLE. WELDED. OTHER	LBS. PER FOOT OR GAGE OF CASING	SEATING BELOW GROUND SURFACE, FT.
<u>76 ft</u>	<u>10</u>		<u>10</u>	<u>75 ft</u>

Type and size of shoe or well ring 2 1/4 in. Welded joints— Yes No

51-123

WATER WELL DRILLERS REPORT

(Sections 7076, 7077, 7078, Water Code)

Do Not Fill In
 State Well No. 31155-3201
 Other Well No. 51-123
 Region 5

(7) Perforations:

Type of perforator used none

Perforated	ft. to	ft. Hole size	No. of holes

(8) Water levels:

Depth at which water first encountered 40 ft.
 Depth to water before perforating _____ ft.
 Depth to water after perforating _____ ft.
 Note any change in water level while drilling
went from 40 to 30

(9) Well pumping test:

Date of test _____ By whom _____
 Depth to water when test started _____ ft.
 G.P.M. at beginning of test _____
 Drawdown from standing level _____ ft.
 G.P.M. at completion of test _____
 Drawdown at completion of test _____ ft.
 Length of time tested _____
 Temperature of water _____
 Was gas present in water? Yes No

(10) General:

Was well gravel packed? no Size of rock _____ Thickness of pack _____
 Was a surface sanitary seal provided? _____
 Were any strata sealed against pollution? Yes No If yes, attach detailed description.
 Strata sealed all sealed to 75' ft
 Was analysis made of water? Yes No If yes, attach copy.
 Was electric log made of well? Yes No If yes, attach copy.
 If well abandoned, was it plugged and sealed? _____
 Method of plugging and sealing _____

FOR OFFICIAL USE ONLY

(11) Location:

North Yuba (X) Section No. 32
 Township 13 North
 Range 5 West
 Base & Meridian Diablo

Show location of well in Section, thus (X)
 Distances to section lines from well, N or S 100 ft. and E or W _____ ft.
 Show location of nearest known well, thus (O)
 Distance to nearest known well 1/2 mi. east

1 MILE

(12) Time of work:

may 28
 Work started date May 9 Completed date June 7
 Date of this report June 7, 1950

WELL DRILLER'S STATEMENT:

This well was drilled under my jurisdiction and this report is true to the best of my knowledge and belief.

[SIGNED] J.B. Brunsdale
 Well Driller
 By _____
 License No. _____ Classification _____
 Dated _____, 19 _____

ORIGINAL
File with DWR

CONFIDENTIAL
Water Code Sec. 13752

STATE OF CALIFORNIA
THE RESOURCES AGENCY
DEPARTMENT OF WATER RESOURCES
WATER WELL DRILLERS REPORT

Do Not Fill In

No 113384

State Well No. _____
Other Well No. 13403E35A

(2) LOCATION OF WELL:

County Placer Owner's number, if any _____

Township, Range, and Section _____

Distance from cities, roads, railroads, etc. _____

(3) TYPE OF WORK (check):

New Well Deepening Reconditioning Destroying

If destruction, describe material and procedure in Item 11. _____

(4) PROPOSED USE (check):

Domestic Industrial Municipal Irrigation Test Well Other

(5) EQUIPMENT:

Rotary Cable Other

(6) CASING INSTALLED:

STEEL:		OTHER:		If gravel packed		
From ft.	To ft.	Diam.	Gage or Wall	Diameter of Bore	From ft.	To ft.
144'		14" x 3/16"	B/W Plate Casing			

Size of shoe or well ring: 14"x6"x3/4" Size of gravel: _____

(7) PERFORATIONS OR SCREEN:

Type of perforation or name of screen _____

From ft.	To ft.	Perf. per row	Rows per ft.	Size in. x in.

(8) CONSTRUCTION:

Was a surface sanitary seal provided? Yes No To what depth _____ ft.

Were any strata sealed against pollution? Yes No If yes, note depth of strata _____

From _____ ft. to _____ ft.

From _____ ft. to _____ ft.

Method of sealing _____

(9) WATER LEVELS:

Depth at which water was first found, if known 32 ft.

Standing level before perforating, if known 32 ft.

Standing level after perforating and developing _____ ft.

(10) WELL TESTS:

Was pump test made? Yes No If yes, by whom? _____

'd: _____ gal./min. with _____ ft. drawdown after _____ hrs.

Temperature of water _____ Was a chemical analysis made? Yes No

Was electric log made of well? Yes No If yes, attach copy _____

(11) WELL LOG:

Total depth 0 ft. Depth of completed well 250 ft.

Formation: Describe by color, character, size of material, and structure

FROM:	TO:	ft. to	ft.
0'	05'	Top Soil	
05'	10'	Red Clay	
10'	18'	Sand & Gravel 2"	
18'	80'	Red Clay & Streaks of Clay & Gravel	
80'	85'	Gray Clay & Gravel	
85'	95'	Brown Clay & Gravel	
95'	97'	Sand & Gravel	
97'	115'	Brown Clay With Traces of Gravel and Clay	
115'	120'	Loose Sand & Clay	
120'	134'	Gray Clay	
134'	155'	Packed Sand	
155'	167'	Brown Brittle Shale	
167'	200'	Blue Clay & Streaks of Blue Shale	
200'	207'	Blue Brown Clay	
207'	240'	Brown Shale	
240'	250'	Blue Shale	
250'	250'+	Blackish Packed Sand	

CONFIDENTIAL LOG
Water Code Sec. 13752

Work started 2/2/ 19 77, Completed 2/14/ 19 77

WELL DRILLER'S STATEMENT:
This well was drilled under my jurisdiction and this report is true to the best of my knowledge and belief.

NAME Frank L. Cornwell & Son
(Person, firm, or corporation) (Typed or printed)

Address 521 1/2 3rd St. Marysville, California 95901

[SIGNED] [Signature]
(Well Driller)

License No. _____ Dated _____, 19 _____

SKETCH LOCATION OF WELL ON REVERSE SIDE

Geologic Section B-B'

USGS-CAL-T1
May 1948

UNITED STATES
DEPARTMENT OF THE INTERIOR
GEOLOGICAL SURVEY
WATER RESOURCES BRANCH

DWR Log No. 51-014

No. 11/3E-281

Other Nos. 20-9

DWR J

WELL LOG

State California County Sutter Subarea Vernon

Owner _____

Location _____

Drilled by Coupe Address _____

Date Jan. 1932 Casing diam. 16 and 12' Land-surf. alt. 20

Source of data Metopes

(Enter type of well, perforations, yield, and drawdown at end of log)

Correlation	Material	Thick-ness (feet)	Depth (feet)
	Top soil		3
	Hard pan		6
	Brown clay		10
	Sand		12
	Brown clay		45
	Blue clay		98
	Blue sand		125
	Blue sand and gravel		138

Record by _____ Date _____ Sheet _____ of _____

MD 11N/3E-201 201

REGION _____

DIVISION OF WATER RESOURCES

BASIN _____

COUNTY Sutter

DEPARTMENT OF PUBLIC WORKS
STATE OF CALIFORNIA

DWR No. 113-201-201 B & M

NEAR _____

WELL LOG

OTHER Nos. 20-9A

DWR Log No: 51-015

LOCATION Feather River, NE. 1/4 Sec. 2, T. 11 N., R. 3 E., South Portion

OWNER _____ ADDRESS _____

DRILLED BY Francis Coupe ADDRESS _____

DRILLING METHOD _____ GRAVEL PACKED _____ DATE COMPLETED March 13, 1932

SIZE OF CASING DEPTH _____ STRUCK WATER AT _____

PERFORATIONS _____ SIZE 16, 12, and 10 No.

WATER LEVEL BEFORE PERFORATING _____ AFTER _____

TEST DATA: DISCHARGE G. P. M. _____ DRAWDOWN FT. _____ HOURS RUN _____

OTHER DATA AVAILABLE: WATER LEVEL RECORD _____ ANALYSIS _____

SURFACE ELEV. _____ DATUM _____ SOURCE OF INFORMATION Natomas Co.

DEPTH	ELEV. OF BOTTOM OF STRATUM	MATERIAL	THICKNESS	SP. YIELD %
17		Brown clay		
19		Brown sand		
45		Brown clay		
80		Blue clay		
90		Fine Blue sand		
100		Blue sandy clay		
122		Blue sand		
125		Brown sandy clay		
128		Blue sand		

FOR FIELD COPIES USE ALTERNATE LINES

LOG OBTAINED BY ok DATE 11-1-48 SHEET 1 OF 546

REGION _____
 COUNTY Sutter
 NEAR _____

DIVISION OF WATER RESOURCES
 DEPARTMENT OF PUBLIC WORKS
 STATE OF CALIFORNIA

BASIN _____
 DWR NO. 113 3C2 B & M
 OTHER NOS. 20-8

WELL LOG

21

LOCATION Natomas, Feather River, NE 1/4 Sec. 3, T. 11 N., R. 3 E., F-1 Property
for F. R. Pump Unit No. 3

OWNER _____ ADDRESS _____

DRILLED BY Vernon McGrew ADDRESS _____

DRILLING METHOD _____ GRAVEL PACKED _____ DATE COMPLETED May 1937

SIZE OF CASING DEPTH _____ STRUCK WATER AT _____

PERFORATIONS _____ SIZE 1 1/4" No. _____

WATER LEVEL BEFORE PERFORATING _____ AFTER _____

TEST DATA: DISCHARGE G. P. M. _____ DRAWDOWN FT. _____ HOURS RUN _____

OTHER DATA AVAILABLE: WATER LEVEL RECORD _____ ANALYSIS _____

SURFACE ELEV. _____ DATUM _____ SOURCE OF INFORMATION Natomas

DEPTH	ELEV. OF BOTTOM OF STRATUM	MATERIAL	THICKNESS	SP. YIELD %
18		Soil and silt		
35		Sand and small gravel		
87		Clay		
95		Hard sand		
110		Tight gravel		
		Loose gravel		

FOR FIELD COPIES USE ALTERNATE LINES

LOG OBTAINED BY ok DATE 11-1-48 SHEET 1 OF 514

WATER WELL DRILLERS REPORT

(Sections 7076, 7077, 7078, Water Code)

STATE OF CALIFORNIA—DEPARTMENT OF PUBLIC WORKS

DIVISION OF WATER RESOURCES 253

DWR Log No: 51-050;
LOCATION NOT CHECKED
Do Not Fill In

State Well No. _____
Other Well No. 11N-4E-4A
Region _____

D O M E I D E
Section 7076
Water Code

(1) DRILLER: (person, firm, or corporation)
Name Frank P. Conley
Address 432-Feather River Blvd
Marysville, Calif.

(8) LOCATION OF WELL:
County Sutter
R. F. D. or Street No. On levee road - 3/4 mile north of Howsley Rd. Pleasant Grove, Calif.

OWNER:
Name _____
Address _____

(2) Proposed Use (Check)	Equipment
Domestic <input type="checkbox"/>	Rotary <input type="checkbox"/>
Irrigation <input checked="" type="checkbox"/>	Cable <input checked="" type="checkbox"/>
Municipal <input type="checkbox"/>	Dug Well <input type="checkbox"/>
Industrial <input type="checkbox"/>	Other <input type="checkbox"/>
Test Well <input type="checkbox"/>	
Other <input type="checkbox"/>	

(3) CASING:

Liners	ft. of	in	lb./ga. casing	ft	left in well
48	12	10	48		
40	10	12	40		
60	8	12	60		

Type and size of shoe or well ring 12" 3x3/8

(4) PERFORATIONS:

Type of perforator used	Perforated	ft. to	ft.	holes per	in.
<u>Burnt with acetylene</u>	180	216	7	12	
	275	291	5	12	
	330	390	5	12	

Diameter of perforations 1/4 in., length 3 in.

(5) WATER LEVELS:
Was electric log made of well? Yes No If yes, attach copy.
Depth at which water was first found 20 ft.
Standing level before perforating 20 ft.
Standing level after perforating 20 ft.
Note your observation of any change in water level while drilling _____
Was a surface sanitary seal provided? No

(6) WELL PUMPING TEST: Tested by 20 m Wilson Woodland
Capacity 1700 gal./min. 85 ft. draw down
Was well gravel packed? No
Were any strata sealed against pollution? No
Temperature _____ Was a chemical analysis made? _____ Attach copy _____
If abandoned was well capped? _____

(7) TYPE OF WORK (check):
New well Reconditioning of well
Deepening existing well

(9) WELL LOG:
Total depth of well 400 ft.
Formation: Mention size of water gravel—
0 ft. to 207 ft. old hole
207 " 280 " sand run-in
280 " 300 " gravel
300 " 310 " sand
310 " 355 " brown clay
355 " 365 " sand - water
365 " 385 " gray clay
385 " 390 " bluish blue clay
390 " 400 " blue sand

FOR OFFICIAL USE ONLY

Work started Nov 20 19 53 Completed Dec 10 19 53
Date of Report December 10 19 53

WELL DRILLER'S STATEMENT:
This well was drilled under my jurisdiction and this report is true to the best of my knowledge and belief.
[SIGNED] Frank P. Conley
Well Driller
By Bernice Freeborn
License No. 105346 Classification C 57
Dated December 10 19 53

WATER WELL DRILLERS REPORT

(Sections 7076, 7077, 7078, Water Code)

STATE OF CALIFORNIA—DEPARTMENT OF PUBLIC WORKS
DIVISION OF WATER RESOURCES / 86

LOCATION, NOT CHECKED!
DWR Log No: 51-051

State Well No. _____
Other Well No. 11M-4E-5C
Region 5

Section 7076
State of California
Department of Public Works
Division of Water Resources

(1) DRILLER: (person, firm, or corporation)
Name Frank P. Conley
Address 432 - Feather River Blvd., Marysville, Calif.

OWNER:
Name _____
Address _____

(2) Proposed Use (Check)				Equipment	
Domestic	<input type="checkbox"/>	Industrial	<input type="checkbox"/>	Rotary	<input type="checkbox"/>
Irrigation	<input checked="" type="checkbox"/>	Test Well	<input type="checkbox"/>	Cable	<input checked="" type="checkbox"/>
Municipal	<input type="checkbox"/>	Other	<input type="checkbox"/>	Dug Well	<input type="checkbox"/>
				Other	<input type="checkbox"/>

(3) CASING:
105 ft. of 14 in 3/16 lb./sq. casing 104 1/2 left in well
" " " " " " " " " " " " " " " " " " "
" " " " " " " " " " " " " " " " " " "
" " " " " " " " " " " " " " " " " " "
" " " " " " " " " " " " " " " " " " "
Type and size of shoe or well ring 14" 4x 1/2

(4) PERFORATIONS:

Type of perforator used				
Perforated	ft. to	ft.	holes per	in.
"	"	"	"	"
"	"	"	"	"
"	"	"	"	"
"	"	"	"	"
"	"	"	"	"
"	"	"	"	"
"	"	"	"	"
"	"	"	"	"
"	"	"	"	"
"	"	"	"	"
"	"	"	"	"
"	"	"	"	"
"	"	"	"	"
"	"	"	"	"
"	"	"	"	"
"	"	"	"	"
Diameter of perforations	in., length		in.	

(5) WATER LEVELS:
Was electric log made of well? Yes No If yes, attach copy.
Depth at which water was first found 14 ft.
Standing level before perforating _____ ft.
Standing level after perforating _____ ft.
Note your observation of any change in water level while drilling _____
Was a surface sanitary seal provided? No

(6) WELL PUMPING TEST:
Capacity 2000 gal./min. 50 ft. draw down
Was well gravel packed? No
Were any strata sealed against pollution? _____
Temperature _____ Was a chemical analysis made? _____ Attach copy
If abandoned was well capped? _____

(7) TYPE OF WORK (check):
New well Reconditioning of well
Deepening existing well

(8) LOCATION OF WELL:
County Sutter
R. F. D. or Street No. South side of Catlett Rd. - approx 3/4 mile west of El Centro Rd.

(9) WELL LOG:

Total depth of well	ft.	Formation: Mention size of water gravel—
0	to 16	tough clay
16	to 40	sand
40	to 75	brown clay
75	to 105	blue sand
105	to 120	dark clay
120	to 130	gravel
130	to 145	hard

FOR OFFICIAL USE ONLY

Work started Feb 4 19 53 Completed Feb 9 19 53
Date of Report Mar. 25 19 53

WELL DRILLER'S STATEMENT:
This well was drilled under my jurisdiction and this report is true to the best of my knowledge and belief.
[SIGNED] Frank P. Conley
Bernice Freeborn Well Driller
License No. 105346 Classification C57
Date Mar. 25 19 53
46370 7-51 30M QUIN (S) SPO

WATER WELL DRILLERS REPORT

(Sections 7076, 7077, 7078, Water Code)

STATE OF CALIFORNIA—DEPARTMENT OF PUBLIC WORKS
 DIVISION OF WATER RESOURCES **228**

DWR Log No: 51-1720
 LOCATION **RECHECKED**
 State Well No. **12N 3E-36Q2**
 Other Well No. **12N 4E-37E**
 Region.....

(1) DRILLER: (person, firm, or corporation)
 Name Frank P. Conley
 Address 432 - Feather River Blvd.
 Marysville, Calif.
 OWN
 Name _____
 Address _____

(8) LOCATION OF WELL:
 County Sutter
 R. F. D. or Street No. On Ukropina ranch
 Catlett Rd. - 2 miles
 west of El Centro Blvd. -
 back of equipment shed
 Pleasant Grove, Calif.

Proposed Use (Check)		Equipment	
Domestic	<input type="checkbox"/>	Industrial	<input type="checkbox"/>
Irrigation	<input checked="" type="checkbox"/>	Test Well	<input type="checkbox"/>
Municipal	<input type="checkbox"/>	Other	<input type="checkbox"/>
		Rotary	<input type="checkbox"/>
		Cable	<input checked="" type="checkbox"/>
		Dug Well	<input type="checkbox"/>
		Other	<input type="checkbox"/>

(3) CASING:
176 ft. of 14 in 10 lb./sq. casing 175 1/2 left in well
 Type and size of shoe or well ring 14" 4 x 1/2

(9) WELL LOG:
 Total depth of well **240** ft.
 Formation: Mention size of water gravel—

0	ft. to	2	ft.	
				<u>top soil</u>
				<u>hardpan</u>
				<u>sandy clay</u>
				<u>gray clay</u>
				<u>sand</u>
				<u>blue clay</u>
				<u>sand</u>
				<u>blue sandy clay</u>
				<u>blue sand</u>
				<u>blue clay</u>
				<u>gravel</u>
				<u>blue clay</u>
				<u>blue sand</u>
				<u>blue clay</u>

(4) PERFORATIONS:
 Type of perforator used mills perforator
 Perforated 125 ft. to 135 ft. 8 holes per 12 in.
153 " 165 " 8 " " 12 "
 Diameter of perforations 3/4 in., length 3 in.

(5) WATER LEVELS:
 Was electric log made of well? Yes No If yes, attach copy.
 Depth at which water was first found 14 ft.
 Standing level before perforating 17 ft.
 Standing level after perforating 14 ft.
 Note your observation of any change in water level while drilling
 Was a surface sanitary seal provided? No

(6) WELL PUMPING TEST:
 Capacity 1150 gal./min. 39 ft. draw down
 Was well gravel packed? No
 Were any strata sealed against pollution? No
 Temperature _____ Was a chemical analysis made? _____ Attach copy _____
 If abandoned was well capped? _____

(7) TYPE OF WORK (check):
 New well Reconditioning of well
 Deepening existing well

FOR OFFICIAL USE ONLY
 Work started Sept. 19 19 53. Completed Sept. 30 19 53
 Date of Report October 6, 19 53
 WELL DRILLER'S STATEMENT:
 This well was drilled under my jurisdiction and this report is true to the best
 of my knowledge and belief.
 [SIGNED] Frank P. Conley
Bernice Freeborn
 Well Driller
 License No. 105346 Classification C57
 Dated October 6, 19 53
 46370 7-51 30M QUIN \oplus SPO



Do Not Fill In

State Well No. 124455-33P1
Other Well No. _____
Region _____

WATER WELL DRILLERS REPORT

(Sections 7076, 7077, 7078, Water Code)

119

(1) Driller:
Name Frank P. Conley
Address 432 - Feather River Blvd
Mariposa, Calif.
License No. 105346 Classification DC 57

(2) Proposed use or uses (*check*):
Domestic Irrigation Domestic and Irrigation Other _____
Municipal Industrial Test well Other _____

(3) Equipment used (*check*):
Rotary Cable Dug well Other _____

Owner Name _____
Address _____

(4) Type of work (*check*):
New well Deepening existing well
Reconditioning of well

(5) Well log:
Total depth of well 185 ft.

Give details of formations penetrated, such as silt, peat, muck, sand, gravel, clay, shale, sandstone, hardpan, rock. Include size of gravel (diameter) and sand (fine, medium, coarse), color of material, structure (loose, packed, cemented, soft, hard, brittle).

Depth From Ground Surface

ft. to	ft.	Formations
6	6	top soil
6	20	coarse granulated sand X
20	35	blue clay
35	45	sand & gravel
45	70	light gray clay
70	80	red sandy
80	88	red soft clay
88	106	cemented granite X
106	115	sandy
115	185	gray clay
185	200	

FOR OFFICIAL USE ONLY

If additional space is required, continue on DWR Form No. 246—Supplement, and attach to respective report copies.

(6) Casing left in well:

LENGTH FT.	DIAMETER INCHES	SINGLE, DOUBLE, WELDED, OTHER	LBS. PER FOOT OR GAGE OF CASING	SEATING BELOW GROUND SURFACE, FT.
91	14"	welded	109	90 1/2
24	12"	"	106	

Type and size of shoe or well ring 14" 3x1/2
Welded joints Yes No

ORIGINAL
File with DWR

STATE OF CALIFORNIA
THE RESOURCES AGENCY
DEPARTMENT OF WATER RESOURCES
WATER WELL DRILLERS REPORT

Do not fill in
No. 209372

Name of Intent No. _____
Permit No. or Date 4/21/83

State Well No. _____
Other Well No. 12N04E34J

(1)
Addr _____
City _____
(2) LOCATION OF WELL (See instructions):
County Sutter Owner's Well Number _____
Well address if different from above same
Township _____ Range _____ Section _____
Distance from cities, roads, railroads, fences, etc. 45' west of house, between corner of garage and tree.

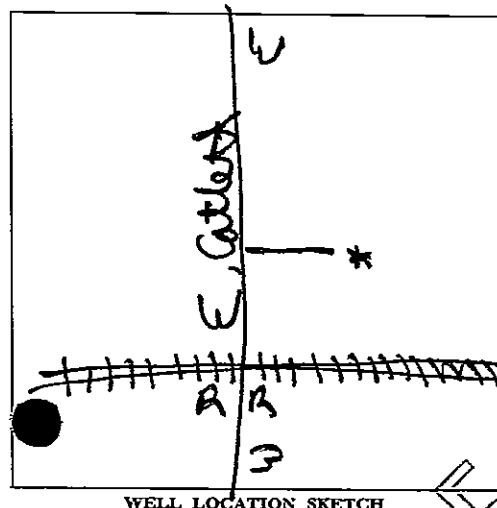

(3) TYPE OF WORK:
New Well Deepening
Reconstruction
Reconditioning
Horizontal Well
Destruction (Describe destruction materials and procedures in Item 12)
(4) PROPOSED USE:
Domestic
Irrigation
Industrial
Test Well
Stock
Municipal
Other

(12) WELL LOG: Total depth 165 ft. Depth of completed well 135 ft.

from ft.	to ft.	Formation (Describe by color, character, size or material)
0	-	1 top soil
1	-	8 coarse granite sand WB
8	-	17 yellow tough clay
17	-	27 brown sandy clay
27	-	37 coarse granite sand & sm. grav. WB
37	-	52 brown tough clay
52	-	61 red sandy clay
61	-	64 yellow soft clay
64	-	71 yellow tough clay
71	-	77 brown sandy brittle clay
77	-	81 yellow tough clay
81	-	85 brown sandy brittle clay
85	-	103 yellow silty clay
103	-	106 yellow shale clay
106	-	114 brown sandy clay
114	-	119 gray fine packed sand WB
119	-	130 yellow sandy clay
130	-	137 yellow tough clay
137	-	144 brown sandy brittle clay
144	-	155 yellow tough clay / br. coarse loose

(5) EQUIPMENT:
Rotary Reverse
Cable Air
Other Bucket

(6) GRAVEL PACK:
Yes No Size _____
Diameter of bore _____
Packed from _____ to _____ ft.

(7) CASING INSTALLED:
Steel Plastic Concrete

(8) PERFORATIONS:
Type of perforation or size of screen _____

From ft.	To ft.	Dia. in.	Gage or Wall	From ft.	To ft.	Slot size
0	80	10	10 ga			

(9) WELL SEAL:
Was surface sanitary seal provided? Yes No If yes, to depth _____ ft.
Were strata sealed against pollution? Yes No Interval _____ ft.
Method of sealing _____

(10) WATER LEVELS:
Depth of first water, if known 1 ft.
Standing level after well completion 9 ft.

(11) WELL TESTS:
Was well test made? Yes No If yes, by whom? _____
Type of test Pump Bailer Air lift
Depth to water at start of test _____ ft. At end of test _____ ft.
Discharge _____ gal/min after _____ hours Water temperature _____
Chemical analysis made? Yes No If yes, by whom? _____
Was electric log made? Yes No If yes, attach copy to this report

Work started 4/8 19 83 Completed 4/19 19 83

WELL DRILLER'S STATEMENT: sand & sm. grav. WB
This well was drilled under my jurisdiction and this report is true to the best of my knowledge and belief.

SIGNED John A. Beebe (Well Driller)
NAME John A. Beebe (Person, firm, or corporation) (Typed or printed)
Address 2574 16th St.
City Sacramento Zip 95818
License No. 392469 Date of this report 4/21/83

CONFIDENTIAL LOG
 Water Code Sec. 13752 STATE OF CALIFORNIA
 THE RESOURCES AGENCY
 DEPARTMENT OF WATER RESOURCES
 WATER WELL DRILLERS REPORT

Do Not Fill In

No 115437

ORIGINAL
File with DWR

State Well No. _____
 Other Well No. 12N/4E-35P

(1) OWNER: Name _____ Address _____ (2) LOCATION OF WELL: County <u>SUTTER</u> Owner's number, if any <u>75-1</u> Township, Range, and Section <u>12N, R4E, Sec. 35</u> Distance from cities, roads, railroads, etc. <u>2 1/2 mi. E. on Cattlet Rd., off Hwy. 99, 100' north.</u> (3) TYPE OF WORK (check): New Well <input checked="" type="checkbox"/> Deepening <input type="checkbox"/> Reconditioning <input type="checkbox"/> Destroying <input type="checkbox"/> If destruction, describe material and procedure in Item 11.					(11) WELL LOG: Total depth <u>410</u> ft. Depth of completed well <u>400</u> ft. Formation: Describe by color, character, size of material, and structure <table border="1" style="width:100%; border-collapse: collapse;"> <tr> <td style="width:10%; text-align: center;">0</td> <td style="width:10%; text-align: center;">16</td> <td style="width:10%; text-align: center;">ft. to</td> <td style="width:60%;"><u>Hard pan & red clay</u></td> <td style="width:10%;"></td> </tr> <tr> <td style="text-align: center;">16</td> <td style="text-align: center;">19</td> <td></td> <td><u>Loose course sand</u></td> <td></td> </tr> <tr> <td style="text-align: center;">19</td> <td style="text-align: center;">29</td> <td></td> <td><u>Red clay & sand</u></td> <td></td> </tr> <tr> <td style="text-align: center;">29</td> <td style="text-align: center;">53</td> <td></td> <td><u>Clay</u></td> <td></td> </tr> <tr> <td style="text-align: center;">53</td> <td style="text-align: center;">57</td> <td></td> <td><u>Sand & clay stringers</u></td> <td></td> </tr> <tr> <td style="text-align: center;">57</td> <td style="text-align: center;">64</td> <td></td> <td><u>Clay</u></td> <td></td> </tr> <tr> <td style="text-align: center;">64</td> <td style="text-align: center;">69</td> <td></td> <td><u>Sandy clay stringers</u></td> <td></td> </tr> <tr> <td style="text-align: center;">69</td> <td style="text-align: center;">100</td> <td></td> <td><u>Clay</u></td> <td></td> </tr> <tr> <td style="text-align: center;">100</td> <td style="text-align: center;">105</td> <td></td> <td><u>Loose sand</u></td> <td></td> </tr> <tr> <td style="text-align: center;">105</td> <td style="text-align: center;">125</td> <td></td> <td><u>Yellow clay</u></td> <td></td> </tr> <tr> <td style="text-align: center;">125</td> <td style="text-align: center;">130</td> <td></td> <td><u>Course gravel & sand and shale</u></td> <td></td> </tr> <tr> <td style="text-align: center;">130</td> <td style="text-align: center;">136</td> <td></td> <td><u>Yellow clay</u></td> <td></td> </tr> <tr> <td style="text-align: center;">136</td> <td style="text-align: center;">143</td> <td></td> <td><u>Loose sand & layered shale</u></td> <td></td> </tr> <tr> <td style="text-align: center;">143</td> <td style="text-align: center;">160</td> <td></td> <td><u>Hard yellow clay</u></td> <td></td> </tr> <tr> <td style="text-align: center;">160</td> <td style="text-align: center;">182</td> <td></td> <td><u>Hard layer of shale</u></td> <td></td> </tr> <tr> <td style="text-align: center;">182</td> <td style="text-align: center;">214</td> <td></td> <td><u>Hard yellow clay</u></td> <td></td> </tr> <tr> <td style="text-align: center;">214</td> <td style="text-align: center;">221</td> <td></td> <td><u>Hard yellow clay with layer of hard shale</u></td> <td></td> </tr> <tr> <td style="text-align: center;">221</td> <td style="text-align: center;">229</td> <td></td> <td><u>Loose sand and gravel</u></td> <td></td> </tr> <tr> <td style="text-align: center;">229</td> <td style="text-align: center;">233</td> <td></td> <td><u>Hard yellow clay</u></td> <td></td> </tr> <tr> <td style="text-align: center;">233</td> <td style="text-align: center;">242</td> <td></td> <td><u>Broken shale</u></td> <td></td> </tr> <tr> <td style="text-align: center;">242</td> <td style="text-align: center;">259</td> <td></td> <td><u>Hard yellow clay</u></td> <td></td> </tr> <tr> <td style="text-align: center;">259</td> <td style="text-align: center;">279</td> <td></td> <td><u>Loose sand & small gravel</u></td> <td></td> </tr> <tr> <td style="text-align: center;">279</td> <td style="text-align: center;">312</td> <td></td> <td><u>Hard clay and shale</u></td> <td></td> </tr> <tr> <td style="text-align: center;">312</td> <td style="text-align: center;">331</td> <td></td> <td><u>Hard sandy yellow shale</u></td> <td></td> </tr> <tr> <td style="text-align: center;">331</td> <td style="text-align: center;">349</td> <td></td> <td><u>Sand gravel, layers of shale</u></td> <td></td> </tr> <tr> <td style="text-align: center;">349</td> <td style="text-align: center;">354</td> <td></td> <td><u>Sandy blue clay</u></td> <td></td> </tr> <tr> <td style="text-align: center;">354</td> <td style="text-align: center;">360</td> <td></td> <td><u>Sand, gravel and shale</u></td> <td></td> </tr> <tr> <td style="text-align: center;">360</td> <td style="text-align: center;">370</td> <td></td> <td><u>Hard blue clay</u></td> <td></td> </tr> <tr> <td style="text-align: center;">370</td> <td style="text-align: center;">390</td> <td></td> <td><u>Sand and gravel</u></td> <td></td> </tr> <tr> <td style="text-align: center;">390</td> <td style="text-align: center;">410</td> <td></td> <td><u>Hard clay</u></td> <td></td> </tr> </table>					0	16	ft. to	<u>Hard pan & red clay</u>		16	19		<u>Loose course sand</u>		19	29		<u>Red clay & sand</u>		29	53		<u>Clay</u>		53	57		<u>Sand & clay stringers</u>		57	64		<u>Clay</u>		64	69		<u>Sandy clay stringers</u>		69	100		<u>Clay</u>		100	105		<u>Loose sand</u>		105	125		<u>Yellow clay</u>		125	130		<u>Course gravel & sand and shale</u>		130	136		<u>Yellow clay</u>		136	143		<u>Loose sand & layered shale</u>		143	160		<u>Hard yellow clay</u>		160	182		<u>Hard layer of shale</u>		182	214		<u>Hard yellow clay</u>		214	221		<u>Hard yellow clay with layer of hard shale</u>		221	229		<u>Loose sand and gravel</u>		229	233		<u>Hard yellow clay</u>		233	242		<u>Broken shale</u>		242	259		<u>Hard yellow clay</u>		259	279		<u>Loose sand & small gravel</u>		279	312		<u>Hard clay and shale</u>		312	331		<u>Hard sandy yellow shale</u>		331	349		<u>Sand gravel, layers of shale</u>		349	354		<u>Sandy blue clay</u>		354	360		<u>Sand, gravel and shale</u>		360	370		<u>Hard blue clay</u>		370	390		<u>Sand and gravel</u>		390	410		<u>Hard clay</u>	
0	16	ft. to	<u>Hard pan & red clay</u>																																																																																																																																																												
16	19		<u>Loose course sand</u>																																																																																																																																																												
19	29		<u>Red clay & sand</u>																																																																																																																																																												
29	53		<u>Clay</u>																																																																																																																																																												
53	57		<u>Sand & clay stringers</u>																																																																																																																																																												
57	64		<u>Clay</u>																																																																																																																																																												
64	69		<u>Sandy clay stringers</u>																																																																																																																																																												
69	100		<u>Clay</u>																																																																																																																																																												
100	105		<u>Loose sand</u>																																																																																																																																																												
105	125		<u>Yellow clay</u>																																																																																																																																																												
125	130		<u>Course gravel & sand and shale</u>																																																																																																																																																												
130	136		<u>Yellow clay</u>																																																																																																																																																												
136	143		<u>Loose sand & layered shale</u>																																																																																																																																																												
143	160		<u>Hard yellow clay</u>																																																																																																																																																												
160	182		<u>Hard layer of shale</u>																																																																																																																																																												
182	214		<u>Hard yellow clay</u>																																																																																																																																																												
214	221		<u>Hard yellow clay with layer of hard shale</u>																																																																																																																																																												
221	229		<u>Loose sand and gravel</u>																																																																																																																																																												
229	233		<u>Hard yellow clay</u>																																																																																																																																																												
233	242		<u>Broken shale</u>																																																																																																																																																												
242	259		<u>Hard yellow clay</u>																																																																																																																																																												
259	279		<u>Loose sand & small gravel</u>																																																																																																																																																												
279	312		<u>Hard clay and shale</u>																																																																																																																																																												
312	331		<u>Hard sandy yellow shale</u>																																																																																																																																																												
331	349		<u>Sand gravel, layers of shale</u>																																																																																																																																																												
349	354		<u>Sandy blue clay</u>																																																																																																																																																												
354	360		<u>Sand, gravel and shale</u>																																																																																																																																																												
360	370		<u>Hard blue clay</u>																																																																																																																																																												
370	390		<u>Sand and gravel</u>																																																																																																																																																												
390	410		<u>Hard clay</u>																																																																																																																																																												
(4) PROPOSED USE (check): Domestic <input type="checkbox"/> Industrial <input type="checkbox"/> Municipal <input type="checkbox"/> Irrigation <input checked="" type="checkbox"/> Test Well <input type="checkbox"/> Other <input type="checkbox"/>					(5) EQUIPMENT: Rotary <input checked="" type="checkbox"/> Cable <input type="checkbox"/> Other <input type="checkbox"/>																																																																																																																																																										
(6) CASING INSTALLED: STEEL <input checked="" type="checkbox"/> OTHER: _____ SINGLE <input type="checkbox"/> DOUBLE <input type="checkbox"/> <table border="1" style="width:100%; border-collapse: collapse; margin-top: 10px;"> <thead> <tr> <th>From ft.</th> <th>To ft.</th> <th>Diam.</th> <th>Gage or Wall</th> <th>Diameter of Bore</th> <th>From ft.</th> <th>To ft.</th> </tr> </thead> <tbody> <tr> <td>0</td> <td>137</td> <td>16" OD</td> <td>1/4"</td> <td>26"</td> <td>0</td> <td></td> </tr> <tr> <td>157</td> <td>191</td> <td>"</td> <td>"</td> <td>"</td> <td></td> <td></td> </tr> <tr> <td>278</td> <td>326</td> <td>"</td> <td>"</td> <td>"</td> <td></td> <td></td> </tr> <tr> <td>390</td> <td>400</td> <td>"</td> <td>"</td> <td>"</td> <td></td> <td></td> </tr> </tbody> </table> Describe joint: <u>Collared Welded</u> Size of shoe or well ring: _____ Size of gravel: <u>MIX #31</u>					From ft.	To ft.	Diam.	Gage or Wall	Diameter of Bore	From ft.	To ft.	0	137	16" OD	1/4"	26"	0		157	191	"	"	"			278	326	"	"	"			390	400	"	"	"																																																																																																																										
From ft.	To ft.	Diam.	Gage or Wall	Diameter of Bore	From ft.	To ft.																																																																																																																																																									
0	137	16" OD	1/4"	26"	0																																																																																																																																																										
157	191	"	"	"																																																																																																																																																											
278	326	"	"	"																																																																																																																																																											
390	400	"	"	"																																																																																																																																																											
(7) PERFORATIONS OR SCREEN: Type of perforation or name of screen <u>Milled Slot & Fulflo</u> <table border="1" style="width:100%; border-collapse: collapse; margin-top: 10px;"> <thead> <tr> <th>From ft.</th> <th>To ft.</th> <th>Perf. per row</th> <th>Rows per ft.</th> <th>Size in. x in.</th> </tr> </thead> <tbody> <tr> <td>137</td> <td>157</td> <td>16" OD</td> <td>2 1/2 x .125</td> <td>milled slot</td> </tr> <tr> <td>191</td> <td>278</td> <td>"</td> <td>"</td> <td>"</td> </tr> <tr> <td>326</td> <td>350</td> <td>"</td> <td>.125</td> <td>fulflo louvered</td> </tr> <tr> <td>350</td> <td>390</td> <td>"</td> <td>2 1/2 x .125</td> <td>milled slot</td> </tr> </tbody> </table>					From ft.	To ft.	Perf. per row	Rows per ft.	Size in. x in.	137	157	16" OD	2 1/2 x .125	milled slot	191	278	"	"	"	326	350	"	.125	fulflo louvered	350	390	"	2 1/2 x .125	milled slot																																																																																																																																		
From ft.	To ft.	Perf. per row	Rows per ft.	Size in. x in.																																																																																																																																																											
137	157	16" OD	2 1/2 x .125	milled slot																																																																																																																																																											
191	278	"	"	"																																																																																																																																																											
326	350	"	.125	fulflo louvered																																																																																																																																																											
350	390	"	2 1/2 x .125	milled slot																																																																																																																																																											
(8) CONSTRUCTION: Was a surface sanitary seal provided? Yes <input type="checkbox"/> No <input checked="" type="checkbox"/> To what depth _____ ft. Were any strata sealed against pollution? Yes <input type="checkbox"/> No <input type="checkbox"/> If yes, note depth of strata _____ From _____ ft. to _____ ft. From _____ ft. to _____ ft. Method of sealing _____ Work started <u>12/2 19 75</u> Completed <u>12/9 19 75</u>																																																																																																																																																															
(9) WATER LEVELS: Depth at which water was first found, if known _____ ft. Standing level before perforating, if known _____ ft. Standing level after perforating and developing <u>18'</u> ft.																																																																																																																																																															
(10) WELL TESTS: Was pump test made? Yes <input checked="" type="checkbox"/> No <input type="checkbox"/> If yes, by whom? <u>EELCOINC</u> Yield: <u>1200</u> gal./min. with <u>101</u> ft. drawdown after <u>2</u> hrs. Temperature of water _____ Was a chemical analysis made? Yes <input type="checkbox"/> No <input checked="" type="checkbox"/> Was electric log made of well? Yes <input checked="" type="checkbox"/> No <input type="checkbox"/> If yes, attach copy																																																																																																																																																															

WELL DRILLER'S STATEMENT:
 This well was drilled under my jurisdiction and this report is true to the best of my knowledge and belief.
 NAME E. E. LUHDORFF CO., INC.
 (Person, firm, or corporation) (Typed or printed)
 Address P. O. BOX 1326
WOODLAND, CALIFORNIA 94695
 [SIGNED] _____
 (Well Driller)
 License No. 276625 Dated 1-9-76, 1976

SKETCH LOCATION OF WELL ON REVERSE SIDE

CONFIDENTIAL LOG
 Water Code Sec. 13752
 67132-750 8-72 30M TRIP ©T OSP

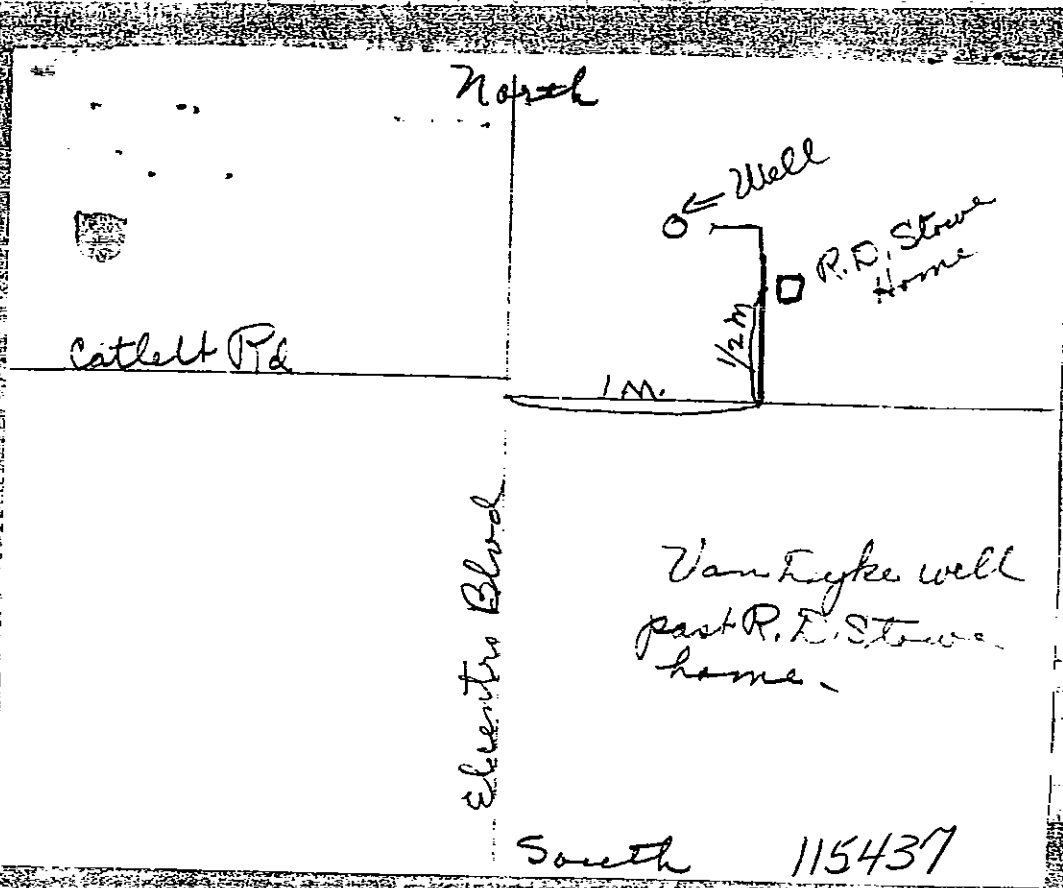

RECEIVED
DIV. OF WATER RESOURCES
SACRAMENTO

OCT 9 1951

COPIED

USGS-CAL-T1
May 1948

UNITED STATES
DEPARTMENT OF THE INTERIOR
GEOLOGICAL SURVEY
WATER RESOURCES BRANCH

51-831

No. 12/ LE - 3681

Other Nos. _____

WELL LOG

State California County Sutter Subarea Pleasant Grove

Owner _____

Location _____

Drilled by Kirchgater Address _____

Date 1947 Casing diam. 8" Land-surf. alt. 50

Source of data _____

(Enter type of well, perforations, yield, and drawdown at end of log)

Correlation	Material	Thick- ness (feet)	Depth (feet)
	Soil		1
	Adobe		2
	Hardpan		4
	Clay, yellow		17
	Clay, white		28
	Sandstone, soft		78
	Clay, yellow		114
	Sand and clay		119
	Clay		182
	Clay, hard and small gravel		200
	Clay, hard		275
	Coarse sand, small gravel and white clay		280
	Sand, fine		308
	Clay		310
	Sand and gravel, cemented		325
	Clay, blue		350
	Shale		372
	Shale, sand and blue clay		390
	Well began to sluff in from 360-390' water level 25'		

Record by _____ Date _____

Sheet _____ of _____

(1) DRILLER: (person, firm, or corporation)
Name Frank P. Conley
Address 432 - Feather River Blvd.,
Marysville, Calif.

OWNE
Name _____
Address _____

(2) Proposed Use (Check) Equipment

Domestic	<input type="checkbox"/>	Industrial	<input type="checkbox"/>	Rotary	<input type="checkbox"/>
Irrigation	<input checked="" type="checkbox"/>	Test Well	<input type="checkbox"/>	Cable	<input checked="" type="checkbox"/>
Municipal	<input type="checkbox"/>	Other	<input checked="" type="checkbox"/>	Dug Well	<input checked="" type="checkbox"/>
				Other	<input type="checkbox"/>

(3) CASING:
60 ft. of 12 in 10 lb./ga. casing 60 left in well
" " (34) " " " " " "
" " " " " " " "
" " " " " " " "
Type and size of shoe or well ring 12" 3 X 3/8 1-035 03

(4) PERFORATIONS:
Type of perforator used burnt with acetylene
Perforated 155 ft. to 175 ft. 6 holes per 12 in.
" " " " " " " "
" " " " " " " "
" " " " " " " "
" " " " " " " "
" " " " " " " "
" " " " " " " "
" " " " " " " "
" " " " " " " "
" " " " " " " "
Diameter of perforations 1/8 in., length 3 in.

(5) WATER LEVELS:
Was electric log made of well? Yes No If yes, attach copy.
Depth at which water was first found 30 ft.
Standing level before perforating 30 ft.
Standing level after perforating 30 ft.
Note your observation of any change in water level while drilling
Was a surface sanitary seal provided? No

(6) WELL PUMPING TEST:
Capacity _____ gal./min. ft. draw down _____
Was well gravel packed? No
Were any strata sealed against pollution? Cemented in int. clay
Temperature _____ Was a chemical analysis made? (attach copy)
If abandoned was well capped? _____

(7) TYPE OF WORK (check):
New well Reconditioning of well
Deepening existing well

(8) LOCATION OF WELL:
County Sutter
R. F. D. or Street No. Catlett Rd. - 1 mile east
of Pleasant Grove Rd.

(9) WELL LOG: Old well 215 ft
Total depth of well 380 Caved in to 160 ft.
Formation: Mention size of water gravel—
160 ft. to 215 ft. sand
215 " 225 " gray clay
225 " 270 " bleached granite
270 " 290 " clay
290 " 300 " lime shale
300 " 370 " clay
370 " 380 " sand

CONFIDENTIAL

FOR OFFICIAL USE ONLY

Work started Nov. 24 19 52 Completed Dec. 15 19 52
Date of Report Jan. 2 19 53

WELL DRILLER'S STATEMENT:
This well was drilled under my jurisdiction and this report is true to the best of my knowledge and belief.
[SIGNED] Frank P. Conley 505
Well Driller
By Bernice Freeborn
License No. 105346 Classification 357
Dated Jan 2 19 53

WATER WELL DRILLERS REPORT
(Sections 7076, 7077, 7078, Water Code)

31-045 **IN CHECKED**
Do Not Fill In

STATE OF CALIFORNIA—DEPARTMENT OF PUBLIC WORKS
DIVISION OF WATER RESOURCES

State Well No. **12N/5E-34H1**
Other Well No. **12N-5E-35**
Region **34H1**

(1) DRILLER: (person, firm, or corporation)

Name **William Flynn**
Address **Box 26 Sutter, Calif**

OWNER:

Name _____
Address _____

(2) Proposed Use (Check)

Domestic	<input type="checkbox"/>	Industrial	<input type="checkbox"/>	Rotary	<input type="checkbox"/>
Irrigation	<input checked="" type="checkbox"/>	Test Well	<input type="checkbox"/>	Cable	<input checked="" type="checkbox"/>
Municipal	<input type="checkbox"/>	Other	<input type="checkbox"/>	Dug Well	<input type="checkbox"/>
				Other	<input type="checkbox"/>

(3) CASING:

150	ft. of	16	in	3/16	lb./ga. casing	150	left in well
"	"	"	"	"	"	"	"
"	"	"	"	"	"	"	"
"	"	"	"	"	"	"	"
"	"	"	"	"	"	"	"

Type and size of shoe or well ring **16" X 3/4" X 6"**

(4) PERFORATIONS:

Type of perforator used **Mills**

Perforated	140	ft. to	148	ft.	16	holes per	per ft.	in.
"	"	"	"	"	"	"	"	"
"	"	"	"	"	"	"	"	"
"	"	"	"	"	"	"	"	"
"	"	"	"	"	"	"	"	"
"	"	"	"	"	"	"	"	"
"	"	"	"	"	"	"	"	"
"	"	"	"	"	"	"	"	"
"	"	"	"	"	"	"	"	"
"	"	"	"	"	"	"	"	"
"	"	"	"	"	"	"	"	"
"	"	"	"	"	"	"	"	"
"	"	"	"	"	"	"	"	"
"	"	"	"	"	"	"	"	"
"	"	"	"	"	"	"	"	"
"	"	"	"	"	"	"	"	"

Diameter of perforations **1/2** in., length **2** in.

(5) WATER LEVELS:

Was electric log made of well? Yes No If yes, attach copy.

Depth at which water was first found **110** ft.

Standing level before perforating **48** ft.

Standing level after perforating **48** ft.

Note your observation of any change in water level while drilling _____

Was a surface sanitary seal provided? _____

(6) WELL PUMPING TEST:

Capacity **850** gal./min. **105** ft. draw down

Was well gravel packed? **no**

Were any strata sealed against pollution? **no**

Temperature _____ Was a chemical analysis made? _____ Attach copy _____

If abandoned was well capped? _____

(7) TYPE OF WORK (check):

New well Reconditioning of well
Deepening existing well

(8) LOCATION OF WELL:

County **Placer**
R. F. D. or Street No. **7 1/2 mi. east of Pacific Ave. on Catlett Rd. and 1/8mi. north of Catlett Rd. (Pacific Ave is 1 mi. east of East Nicolaus)**

(9) WELL LOG:

Total depth of well **470** ft.

Formation: Mention size of water gravel—

0	ft. to	4	ft.	top soil
4	"	110	"	yellow clay
110	"	140	"	red clay
140	"	145	"	packed sand & gravel
145	"	233	"	yellow clay
233	"	274	"	cemented gravel
274	"	331	"	blue clay
331	"	352	"	lava ash
352	"	403	"	blue clay
403	"	408	"	hard sand
408	"	420	"	white clay
420	"	427	"	packed gravel
427	"	465	"	white clay
465	"	470	"	sand and gravel

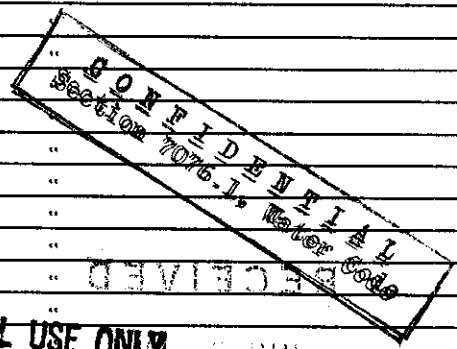

FOR OFFICIAL USE ONLY

Work started **4/23/54** 19, Completed **5/29/54** 19
Date of Report **6/5/54** 19

WELL DRILLER'S STATEMENT:

This well was drilled under my jurisdiction and this report is true to the best of my knowledge and belief.

[SIGNED] **William Flynn**
W. Driller

By _____
License No. **97194** Classification **S.C.57**
Dated **6/5/54** 19

WATER WELL DRILLERS REPORT

(Sections 7079, 7080, 7081, 7082, Water Code)

THE RESOURCES AGENCY OF CALIFORNIA
DEPARTMENT OF WATER RESOURCES

12N/5E-34K1

JUL 20 1967

Do Not Fill In

No. 9468

State Well No. 12N/5E-34K1
Other Well No. 12N/5E-34K1

(1) OWNER:

Name _____
Address _____

(11) WELL LOG:

Total depth **145** ft. Depth of completed well **145** ft.

Formation: Describe by color, character, size of material, and structure

0 to 1 top soil ft. to _____ ft.

(2) LOCATION OF WELL:

County **Placer** Owner's number, if any _____

Township, Range, and Section **12N/5E-34K1**

Distance from cities, roads, railroads, etc. **2 1/2 Mi. east of Brewer Rd. on Pleasant Grove Rd.**

1 " 3 hard pan

3 " 22 red hard clay

(3) TYPE OF WORK (check):

New Well Deepening Reconditioning Destroying

If destruction, describe material and procedure in Item 11.

22 " 36 red silty clay

36 " 62 yellow hard silty clay

(4) PROPOSED USE (check):

Domestic Industrial Municipal
Irrigation Test Well Other

(5) EQUIPMENT:

Rotary
Cable
Other

62 " 74 red tough clay

74 " 78 yellow clay

(6) CASING INSTALLED:

STEEL: SINGLE DOUBLE OTHER:

If gravel packed

From ft.	To ft.	Diam.	Gage or Wall	Diameter of Bore	From ft.	To ft.
0	100	10	10			

78 " 81 gravel & clay mix W.R.

81 " 96 red silty clay

96 " 104 red & yellow tough clay

104 " 107 brown coarse cemented sand W.R.

Size of shoe or well ring: **1/2" X 6" X 10" spiral steel**

Describe joint **ark but welded**

107 " 123 gray coarse tight sand W.R.

(7) PERFORATIONS OR SCREEN:

Type of perforation or name of screen **None**

From ft.	To ft.	Perf. per row	Rows per ft.	Size in. x in.

123 " 138 Gray sand & small gravel W.B.

138 " 145 tight med. & small gravel W.B.

Plotted and Coded

As Well **12N/5E-34K1**

(8) CONSTRUCTION:

Was a surface sanitary seal provided? Yes No To what depth _____ ft.

Were any strata sealed against pollution? Yes No If yes, note depth of strata _____

From _____ ft. to _____ ft.

From _____ ft. to _____ ft.

Method of sealing _____

(9) WATER LEVELS:

Depth at which water was first found, if known **89** ft.

Standing level before perforating, if known **75** ft.

Standing level after perforating and developing _____ ft.

(10) WELL TESTS:

Pump test made? Yes No If yes, by whom? _____

_____ gal./min. with _____ ft. drawdown after _____ hrs.

Temperature of water _____ Was a chemical analysis made? Yes No

Was electric log made of well? Yes No If yes, attach copy _____

FOR OFFICIAL USE ONLY

Work started **May 29 19 67**, Completed **June 7, 19 67**

WELL DRILLER'S STATEMENT:

This well was drilled under my jurisdiction and this report is true to the best of my knowledge and belief.

LYLE W. CORNELIUS
NAME **Well Drilling Contractor**
(Person, firm, or corporation) (Type or print)
1820 First Ave. GI 8-6410
Address **Sacramento 18, Calif.**

[SIGNED] **Lyle W. Cornelius**
(Well Driller)

License No. **142613** Dated **June 10, 19 67**

SKETCH LOCATION OF WELL ON REVERSE SIDE

Geologic Section C-C'

ORIGINAL
File with DWR

CONFIDENTIAL LOG
Water Code Sec. 7080

WATER WELL DRILLERS REPORT
(Sections 7079, 7080, 7081, 7082, Water Code)
THE RESOURCES AGENCY OF CALIFORNIA
DEPARTMENT OF WATER RESOURCES

Do Not Fill In

No. **9491**
State Well No. **11N/3E-36P1**
Other Well No. **11N/3E-36P1**

(1) OWNER:

Name _____
Address _____

(2) LOCATION OF WELL:

County **Sutter** Owner's number, if any **483-7122**
Township, Range, and Section **T- R- S-**
Distance from cities, roads, railroads, etc. **62' west of center Garden Highway & 100' north Rego Rd.**

(3) TYPE OF WORK (check):

New Well Deepening Reconditioning Destroying
If destruction, describe material and procedure in Item 11.

(4) PROPOSED USE (check):

Domestic Industrial Municipal
Irrigation Test Well Other

(5) EQUIPMENT:

Rotary
Cable
Other

(6) CASING INSTALLED:

STEEL: OTHER:
SINGLE DOUBLE

If gravel packed

From ft.	To ft.	Diam.	Gage or Wall	Diameter of Bore	From ft.	To ft.
minus* 6'	157	8"	10			

Size of shoe or well ring: **1/2" X 4" X 8" plus steel**

Describe joint **Ark but welded**

(7) PERFORATIONS OR SCREEN:

Type of perforation or name of screen **none**

From ft.	To ft.	Perf. per row	Rows per ft.	Size in. x in.

(8) CONSTRUCTION:

Was a surface sanitary seal provided? Yes No To what depth **8** ft.

Were any strata sealed against pollution? Yes No If yes, note depth of strata

From _____ ft. to _____ ft.

From _____ ft. to _____ ft.

Method of sealing

(9) WATER LEVELS:

Depth at which water was first found, if known **38** ft.

Standing level before perforating, if known **19** ft.

Standing level after perforating and developing _____ ft.

(10) WELL TESTS:

Was pump test made? Yes No If yes, by whom? **Cornelius**

Rate: **300** gal./min. with **11** ft. drawdown after **4** hrs.

Temperature of water _____ Was a chemical analysis made? Yes No

Was electric log made of well? Yes No If yes, attach copy

(11) WELL LOG:

Total depth **171** ft. Depth of completed well **170** ft.

Formation: Describe by color, character, size of material, and structure
0' to 3' sandy top soil ft.

3" 6' fine sand

6" 19' brown doby clay

19" 38' blue silty clay

38" 40' fine packed sand W.B.

40" 64' blue doby clay

64" 70' blue cemented sand

70" 83' sand & small gravel W.B.

83" 126' blue crumbly clay

126" 154' blue sticky clay

134" 138' blue packed sand W.B.

138" 143' blue sticky clay

143" 148' blue fine quick sand W.B.

148" 157' blue tough sandy clay

157" 171' dark sand & small gravel W.B.

171" large gravel W.B.

CONFIDENTIAL LOG
Water Code Sec 7080

Work started **6 / 20** 19**69** , Completed **6 / 26** 19**69**

WELL DRILLER'S STATEMENT:
This well was drilled under my jurisdiction and this report is true to the best of my knowledge and belief.

NAME **W. W. CORNELIUS**
Well Drilling Contractor
1820 First Ave. GI 8-6410
Sacramento 18, Calif.

Address _____
[SIGNED] *W. W. Cornelius*
(Well Driller)

License No. **142613** Dated **June 27** 19**69**

SKETCH LOCATION OF WELL ON REVERSE SIDE

ORIGINAL
File with DWR

STATE OF CALIFORNIA
THE RESOURCES AGENCY
DEPARTMENT OF WATER RESOURCES
WATER WELL DRILLERS REPORT

Do not fill in
No. 280943

Notice of Intent No. 246643
Local Permit No. or Date 35-032-015

State Well No. _____
Other Well No. 11N03E36R

(1)
A
C

(2) LOCATION OF WELL (See instructions):

County SUTTER Owner's Well Number _____
Well address if different from above 5341 W. Riego RD
Township 11N Range 4E Section 36
Distance from cities, roads, railroads, fences, etc. _____

(12) WELL LOG: Total depth 165 ft. Completed depth _____ ft.
from ft to ft Formation (Describe by color, character, size or material)

0	-	3	TOP SOIL
3	-	15	BROWN STICKY CLAY
15	-	17	Blue Clay
17	-	28	Brown Clay
28	-	29	SAND w.B.
29	-	64	BROWN CLAY
64	-	65	SAND
65	-	99	BROWN CLAY
99	-	141	BROWN CLAY
141	-	143	SAND
143	-	158	Blue Clay
158	-	165	SAND & GRAVEL

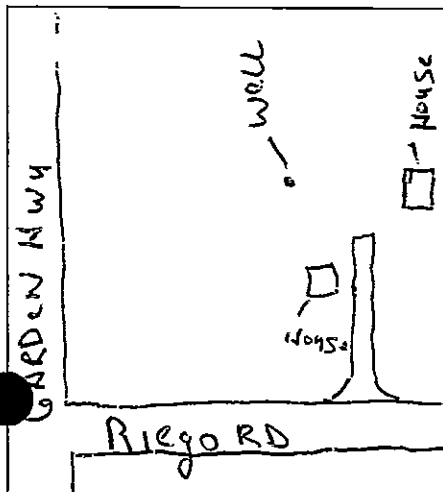

WELL LOCATION SKETCH

(3) TYPE OF WORK:

- New Well Deepening
- Reconstruction
- Reconditioning
- Horizontal Well

Destruction (Describe destruction materials and procedures in Item 12)

(4) PROPOSED USE:

- Domestic
- Irrigation
- Industrial
- Test Well
- Municipal
- Other (Describe)

(5) EQUIPMENT:

- Rotary Reverse
- Cable Air
- Other Bucket

(6) GRAVEL PACK:

- Yes No
- Size _____
- Diameter of bore _____
- Packed from _____ to _____ ft.

(7) CASING INSTALLED:

- Steel Plastic Concrete

(8) PERFORATIONS:

Type of perforation or size of screen _____

From ft	To ft	Dia. in	Gage or Wall	From ft	To ft	Slot size
0	145	8"	156			

(9) WELL SEAL:

Was surface sanitary seal provided? Yes No If yes, to depth 21 ft.
 Were strata sealed against pollution? Yes No Interval _____ ft.
 Method of sealing Bentonite Seal

Work started 1-10 1990 Completed 1-23 1990

(10) WATER LEVELS:

Depth of first water, if known _____ ft.
 Standing level after well completion 15' ft.

WELL DRILLER'S STATEMENT:

This well was drilled under my jurisdiction and this report is true to the best of my knowledge and belief.

(11) WELL TESTS:

Was well test made? Yes No If yes, by whom? _____
 Type of test Pump Bailor Air lift
 Depth to water at start of test _____ ft. At end of test _____ ft.
 Discharge _____ gal/min after _____ hours Water temperature _____
 Chemical analysis made? Yes No If yes, by whom? _____
 Was electric log made? Yes No If yes, attach copy to this report

Signed G. Gakin (Well Driller)
 NAME G. GAKIN Well Drilling (Person, firm, or corporation) (Typed or printed)
 Address 10550 Lowell St.
 City ELVERTA ZIP 95626
 License No. 374391 Date of this report 1-24-90

LOCATION NOT CHECKED

ORIGINAL
File Original, Duplicate and Triplicate with the
REGIONAL WATER POLLUTION
CONTROL BOARD No. _____
(Insert appropriate number)

WATER WELL DRILLERS REPORT

(Sections 7076, 7077, 7078, Water Code)

STATE OF CALIFORNIA

481

Do Not Fill In
Nº 32889

State Well No. _____
Other Well No. 11/4-32889

(1) OWNER:

Name _____
Address _____

(2) LOCATION OF WELL:

County Sutter Owner's number, if any— _____
R. F. D. or Street No. _____
550' W of Marysville Rd.
1500' N of Base Line Road

(3) TYPE OF WORK (check):

New well Deepening Reconditioning Abandon
If abandonment, describe material and procedure in Item 11.

(4) PROPOSED USE (check):

Domestic Industrial Municipal
Irrigation Test Well Other

(5) EQUIPMENT:

Rotary
Cable
Dug Well

(6) CASING INSTALLED:

SINGLE <input checked="" type="checkbox"/> DOUBLE <input type="checkbox"/>				Gage of Wall	If gravel packed		
From	ft. to	ft.	Diam.		Diameter of Bore	from ft.	to ft.
0	76	12	12				

Type and size of shoe or well ring 1/2x4x12 Size of gravel: _____
Describe joint Welded

(7) PERFORATIONS:

Type of perforator used _____						
Size	of perforations		in., length, by		in.	
From	ft. to	ft.	Perf. per row	Rows per ft.		

(8) CONSTRUCTION:

Was a surface sanitary seal provided? Yes No To what depth 76 ft.
Were any strata sealed against pollution? Yes No If yes, note depth of strata _____
From 0 ft. to 76 ft.
Method of Sealing Welded

(9) WATER LEVELS:

Depth at which water was first found 46 ft.
Standing level before perforating _____ ft.
Standing level after perforating _____ ft.

(10) WELL TESTS:

Was a pump test made? Yes No If yes, by whom? _____
Yield: _____ gal./min. with _____ ft. draw down after _____ hrs.
Temperature of water _____ Was a chemical analysis made? Yes No
Was electric log made of well? Yes No

(11) WELL LOG:

Total depth	ft.	Depth of completed well	ft.
187		185	
Formation: Describe by color, character, size of material, and structure.			
0'	ft. to	3'	ft.
			Top Soil
3		10	Hardpan & sand
10		23	Clay, gray
23		32	Clay, brown
32		64	Clay, gray
64		70	Sediment, gray
70		74	Sand
74		150	Clay, gray
150		165	Sandy
165		175	Sediment, blue
175		187	Sand, coarse

CONFIDENTIAL
Section 7076.1, Water Code

FOR OFFICIAL USE ONLY

Work started April 19 56 Completed _____ 19 _____

WELL DRILLER'S STATEMENT:
This well was drilled under my jurisdiction and this report is true to the best of my knowledge and belief.
NAME E. C. Keables, Well Drilling
(Person, firm, or corporation) (Typed or printed)
Address 1700 Glenrose Ave.
N. Sacramento 15, Calif.

[SIGNED] E. C. Keables
Well Driller
License No. 157234 Dated April, 1956

REGION _____

DIVISION OF WATER RESOURCES

BASIN _____

COUNTY Sutter

DEPARTMENT OF PUBLIC WORKS

DWR No. _____ B & M

STATE OF CALIFORNIA

OTHER NOS. 32-16

NEAR _____

WELL LOG

114 33J1

State - California

11/4E-33 51

LOCATION _____

SUBAREA Vernon

OWNER _____ ADDRESS _____

DRILLED BY Thomas J. Fulton ADDRESS Casing diam. 16, 14, and 12"

DRILLING METHOD _____ GRAVEL PACKED _____ DATE COMPLETED Sept. 1947

SIZE OF CASING DEPTH _____ STRUCK WATER AT _____

PERFORATIONS _____ SIZE _____ No. _____

WATER LEVEL BEFORE PERFORATING _____ AFTER _____

TEST DATA: DISCHARGE G. P. M. _____ DRAWDOWN FT. _____ HOURS RUN _____

OTHER DATA AVAILABLE: WATER LEVEL RECORD _____ ANALYSIS _____

SURFACE ELEV. _____ DATUM _____ SOURCE OF INFORMATION Owner

(Enter type of well, perforations, yield, and drawdown at end of log)

FOR FIELD COPIES USE ALTERNATE LINES

DEPTH	ELEV. OF BOTTOM OF STRATUM	MATERIAL	THICKNESS	SP. YIELD %
13		Soft top soil		
16		Brown sand		
32		Gray with pieces brown clay		
39		Soft brown clay		
40		Pea gravel		
71		Hard dark brown clay		
91		Soft brown clay		
93		Black burnt sand		
96		Soft gray sand		
101		Hard gray sand		
139		Soft brown clay		
143		Hard black sand		
145		Black sand		
156		Hard gray clay		
163		Blue clay		
164		Gray sand		
175		Hard blue clay		
181		Soft gray sand		
183		Hard gray sand		
196		Cemented sand and gravel		
199		Hard yellow clay		
201		Gray sand		
219		Soft blue clay		
221		Black sand		
243		Soft blue clay		
247		Hard blue clay		
251		Soft blue clay		
252		Blue sand		
271		Hard blue clay		

LOG OBTAINED BY _____ DATE _____ SHEET 1 OF _____

LOCATION NOT CHECKED

ORIGINAL
File Original, Duplicate and Triplicate with the
REGIONAL WATER POLLUTION
CONTROL BOARD No. _____
(Insert appropriate number)

WATER WELL DRILLERS REPORT

(Sections 7076, 7077, 7078, Water Code)

STATE OF CALIFORNIA

Do Not Fill In
N^o 45210 **35J1**
State Well No. 11N/4E-35J1
Other Well No. 11N/4E-35J1

683

(1) OWNER:
Name _____
Address _____

(2) LOCATION OF WELL:
County Sutter Owner's number, if any—
R. F. D. or Street No. (Pleasea. Grove Rd.)
342' W Old Marysville Rd.
474' N. Riego Road

(3) TYPE OF WORK (check):
New well Deepening Reconditioning Abandon
If abandonment, describe material and procedure in Item 11.

(4) PROPOSED USE (check):
Domestic Industrial Municipal
Irrigation Test Well Other

(5) EQUIPMENT:
Rotary
Cable
Dug Well

(6) CASING INSTALLED:

From	ft. to	ft.	Diam.	Gage or Wall	Diameter of Bore	from ft.	to ft.
1	20	12	12				

Type and size of shoe or well ring none Size of gravel: _____
Describe joint _____

(7) PERFORATIONS:

Type of perforator used _____

Size of perforations	in., length, by	in.		
From	ft. to	ft.	Perf. per row	Rows per ft.

(8) CONSTRUCTION:
Was a surface sanitary seal provided? Yes No To what depth 20 ft.
Were any strata sealed against pollution? Yes No If yes, note depth of strata
From _____ ft. to _____ ft.
Method of Sealing _____

(9) WATER LEVELS:
Depth at which water was first found 54 ft.
Standing level before perforating _____ ft.
Standing level after perforating _____ ft.

(10) WELL TESTS:
Was a pump test made? Yes No If yes, by whom?
Yield: _____ gal./min. with _____ ft. draw down after _____ hrs.
Temperature of water _____ Was a chemical analysis made? Yes No
Was electric log made of well? Yes No

(11) WELL LOG:
Total depth 133 ft. Depth of completed well 133 ft.

Formation: Describe by color, character, size of material, and structure.

0	ft. to	3	ft.	Top Soil
3		50		Clay
50		52		Sand
52		128		Clay
128		133		Sand

official no. 11N/4E-35J1
plots in 35 B5

plot .1 mi W of
P.C. Rd., 26 mi N of
Riego Rd

CONFIDENTIAL
Section 7076.1, Water Code

FOR OFFICIAL USE ONLY

Work started 6/2/58 19 _____ Completed 19 _____

WELL DRILLER'S STATEMENT:
This well was drilled under my jurisdiction and this report is true to the best of my knowledge and belief.
NAME E. C. Keables, Well Drilling
(Person, firm, or corporation) (Typed or printed)
Address 1700 Glenrose Ave., N. Sacto., 15
California

[SIGNED] E. C. Keables
Well Driller
License No. 157234 Dated Jan., 19 59

DUPLICATE
File Original, Duplicate and Triplicate with the
DIVISION OF WATER RESOURCES
P. O. BOX 1079
SACRAMENTO 5, CALIFORNIA

WATER WELL DRILLERS REPORT

(Sections 7076, 7077, 7078, Water Code)

STATE OF CALIFORNIA—DEPARTMENT OF PUBLIC WORKS
DIVISION OF WATER RESOURCES

9168

DWR Log No: 51-190
Do Not Fill In 11/1

State Well No. _____
Other Well No. 11/1-22
Region _____

(1) DRILLER: (person, firm, or corporation)

Name E. C. Keables 101
Address 1700 Glenrose Ave.,
Sacramento, Calif.

OWNER

Name _____
Address _____

(2) Proposed Use (Check)

Domestic Industrial
Irrigation Test Well
Municipal Other 2

Equipment

Rotary
Cable
Dug Well 2
Other

(3) CASING:

88 ft. of 14 in 12 x/ga. casing 88 left in well
122 " " " " " " "
34 Ft. Liner from 138' to 172' " " "
Type and size of shoe or well ring 14" 1-X

(8) LOCATION OF WELL:

County Sutter
R. F. D. or Street No. _____
2376' N Reigo Rd.
1200' W of W.P. Railroad

(9) WELL LOG:

Total depth of well 290 ft.

Formation: Mention size of water gravel—

1	ft. to	3	ft.	Top Soil
3	"	21	"	Harapan
21	"	60	"	Clay
60	"	85	"	Sand
85	"	99	"	Clay
99	"	106	"	Sand
106	"	120	"	Clay
120	"	125	"	Sand
125	"	150	"	Clay
150	"	172	"	Sand
172	"	275	"	Clay
275	"	290	"	Sand, Coarse

(4) PERFORATIONS:

Type of perforator used 0

Perforated	ft. to	ft.	holes per	in.
"	"	"	"	"
"	"	"	"	"
"	"	"	"	"
"	"	"	"	"
"	"	"	"	"
"	"	"	"	"
"	"	"	"	"
"	"	"	"	"
"	"	"	"	"
"	"	"	"	"
"	"	"	"	"

Diameter of perforations _____ in., length _____ in.

(5) WATER LEVELS:

Was electric log made of well? Yes No If yes, attach copy.
Depth at which water was first found 34 ft.
Standing level before perforating _____ ft.
Standing level after perforating _____ ft.
Note your observation of any change in water level while drilling _____
Was a surface sanitary seal provided? Yes 1-3

(6) WELL PUMPING TEST:

Capacity _____ gal./min. ft. draw down _____
Was well gravel packed? 2
Were any strata sealed against pollution? 2
Temperature _____ Was a chemical analysis made? _____ Attach copy _____
If abandoned was well capped? _____

(7) TYPE OF WORK (check):

New well Reconditioning of well
Deepening existing well

FOR OFFICIAL USE ONLY

Work started 4/5/51 19 _____ Completed 4-2-19 19 _____
Date of Report July 1952 19 _____

WELL DRILLER'S STATEMENT:

This well was drilled under my jurisdiction and this report is true to the best of my knowledge and belief.

[SIGNED] E. C. Keables 1-1
Well Driller

By E. C. Keables
License No. 96347 Classification C-57

Dated _____, 19 _____
46370 7-51 30M QUIN © SPO

31-010

DIVISION OF WATER RESOURCES

11N SE 26L2

WATER WELL DRILLERS REPORT

(Sections 7076, 7077, 7078, Water Code)

Player
31

Do Not Fill In

State Well No. 11N/SE-26L2
Other Well No. _____
Region 5

(1) Driller:

Name V. J. McGrew
Address 304 W. El Camino
North Sacramento, California
License No. 17425 Classification A

(2) Proposed use or uses (check):

Domestic
Irrigation
Domestic and Irrigation
Other Stock Well

(3) Equipment used (check):

Rotary
Cable
Dug well
Other _____

Over _____
Name _____
Address _____

(4) Type of work (check):

New well Reconditioning of well
Deepening existing well

(5) Well log:

Total depth of well 100' ft.

Give details of formations penetrated, such as silt, peat, muck, sand, gravel, clay, shale, sandstone, hardpan, rock. Include size of gravel (diameter) and sand (fine, medium, coarse), color of material, structure (loose, packed, cemented, soft, hard, brittle).

Depth From Ground Surface

ft.	to	ft.
0	to	5
5	to	9
9	to	12
12	to	50
50	to	95
95	to	100
	to	
	to	
	to	
	to	
	to	
	to	
	to	
	to	
	to	
	to	
	to	
	to	
	to	
	to	
	to	
	to	
	to	
	to	
	to	
	to	
	to	
	to	

Top Soil	Red	
Hard Pan	Yellow	
Sand	Grey	Fine
Clay Sandy	Yellow	Soft
Clay	White	Packed
Sand	Brown	Soft

*Planned and Colored
As Well 11N SE 26L2*

FOR OFFICIAL USE ONLY

If additional space is required, continue on DWR Form No. 246—Supplement, and attach to respective report copies.

(6) Casing left in well:

LENGTH FT.	DIAMETER INCHES	SINGLE, DOUBLE, WELDED, OTHER	LBS. PER FOOT OR GAGE OF CASING	SEATING BELOW GROUND SURFACE, FT.
4	6	Single	12 ga	3

Type and size of shoe or well ring None Welded joints— Yes No

WATER WELL DRILLERS REPORT

(Sections 7076, 7077, 7078, Water Code)

STATE OF CALIFORNIA

LOCATION ~~NOT~~ CHECKED

No. 1994

State Well No. 11N/SE-3461

Other Well No. 11N/SE-3461

106

(2) LOCATION OF WELL:

County Placer Owner's number, if any—

R. F. D. or Street No.

1500' N. of Base Line Rd.
Sec. 33, T 11 N, R = 5 E
4 1/2 miles E of Reno

(3) TYPE OF WORK (check):

New well Deepening Reconditioning Abandon

If abandonment, describe material and procedure in Item 11.

(4) PROPOSED USE (check):

Domestic Industrial Municipal
Irrigation Test Well Other

(5) EQUIPMENT:

Rotary
Cable
Dug Well

(6) CASING INSTALLED:

SINGLE DOUBLE

From	ft. to	ft.	Diam.	Gage or Wall
<u>1 1/2' below</u>	<u>139 1/2</u>	<u>14</u>	<u>12</u>	"
"	"	"	"	"
"	"	"	"	"
"	"	"	"	"
"	"	"	"	"

If gravel packed

Diameter of Bore	from	to
"	ft.	ft.
"	"	"
"	"	"
"	"	"
"	"	"

Type and size of shoe or well ring 14" 4 x 5/8 Size of gravel:

Describe joint Butt weld

(7) PERFORATIONS:

Type of perforator used

Size of perforations	in., length, by	in.		
From	ft. to	ft.	Perf. per row	Rows per ft.
"	"	"	"	"
"	"	"	"	"
"	"	"	"	"
"	"	"	"	"
"	"	"	"	"

(8) CONSTRUCTION:

Was a surface sanitary seal provided? Yes No To what depth _____ ft.

Were any strata sealed against pollution? Yes No If yes, note depth of strata

From _____ ft. to _____ ft.

Method of Sealing

(9) WATER LEVELS:

Depth at which water was first found 60 ft.

Static level before perforating 65 ft.

Static level after perforating _____ ft.

(10) WELL TESTS:

Was a pump test made? Yes No If yes, by whom?

Yield: _____ gal./min. with _____ ft. draw down after _____ hrs.

Temperature of water _____ Was a chemical analysis made? Yes No

Was electric log made of well? Yes No

(11) WELL LOG:

Total depth 320 ft. Depth of completed well _____ ft.

Formations: Describe by color, character, size of material, and structure.

0	ft. to	1	ft.	
				<u>top soil</u>
<u>1</u>		<u>5</u>		<u>hard pan</u>
<u>5</u>		<u>20</u>		<u>granulated formation</u>
<u>20</u>		<u>30</u>		<u>clay</u>
<u>30</u>		<u>35</u>		<u>coarse sand</u>
<u>35</u>		<u>60</u>		<u>clay</u>
<u>60</u>		<u>65</u>		<u>sandy - 1st water</u>
<u>65</u>		<u>70</u>		<u>clay</u>
<u>70</u>		<u>80</u>		<u>soft & sandy</u>
<u>80</u>		<u>110</u>		<u>clay</u>
<u>110</u>		<u>120</u>		<u>sandy clay</u>
<u>120</u>		<u>185</u>		<u>hard clay</u>
<u>185</u>		<u>195</u>		<u>soft</u>
<u>195</u>		<u>215</u>		<u>clay</u>
<u>215</u>		<u>225</u>		<u>light sand</u>
<u>225</u>		<u>250</u>		<u>hard clay</u>
<u>250</u>		<u>265</u>		<u>sand</u>
<u>265</u>		<u>275</u>		<u>clay</u>
<u>275</u>		<u>297</u>		<u>coarse sand</u>
<u>297</u>		<u>310</u>		<u>red clay</u>
<u>310</u>		<u>320</u>		<u>black sand</u>

Plotted and Coded
As Well 11N SE 3461

FOR OFFICIAL USE ONLY

Work started July 7 1954. Completed July 13 1954

WELL DRILLER'S STATEMENT:

This well was drilled under my jurisdiction and this report is true to the best of my knowledge and belief.

NAME Frank P. Conley

(Person, firm, or corporation) (Typed or printed)

Address 432 Feather River Blvd

Marysville, Calif

[SIGNED] Frank P. Conley

Well Driller

License No. 105346 Dated _____, 19____

